

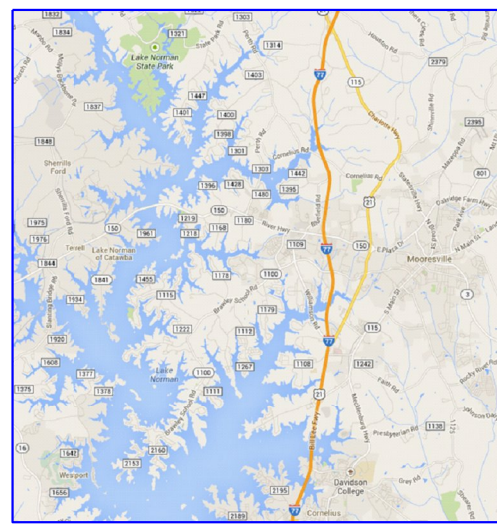

PROPOSED HIGHWAY LANDSCAPE DEVELOPMENT PROJECT

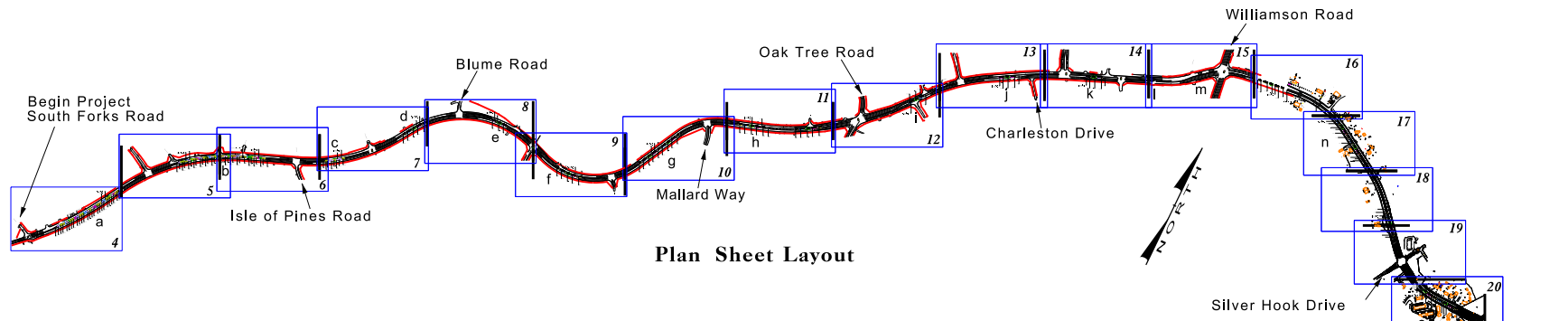

T.I.P. #	STATE PROJECT W.B.S. #	SHEET #	SHEET # TOTAL
		1	20
FED. PROJ. #	DESCRIPTION		DIVISION
	Brawley School Road Median Iredell County		12



Vicinity Map

Plan Sheet Layout

Summary of Quantities

LINE	KEY	SECT	DESCRIPTION	QTY	UNIT
1		SP	Existing Vegetation Removal & Preparation of New Bed Areas - Clearing, Grubbing and Repair	LUMP SUM	LS
2		SP	Plant Bed Establishment (12 Months) - Paid Quarterly	LUMP SUM	LS
3		SP	Soil Amendment	566	CY
4		1664	Zoysia Sod	3,200	SY
5		1664	Water for Sod	400	M/G
6		1670	Double Hammered Pine Bark Mulch for Initial Planting	708	CY
7		1670	Water for Initial Planting	39	MG
8	AGE	1670	<i>Acer palmatum</i> 'Glowing Embers' Glowing Embers Japanese Maple, 2-2.5" Cal. Standard, B&B, Straight Trunk, Matched Specimens	40	EA
9	CM	1670	<i>Cercis Canadensis</i> 'Merlot' Merlot Redbud, 2-2.5" Cal. Standard, B&B, Straight Trunk, Matched Specimens	100	EA
10	CCS	1670	<i>Chionanthus retusus</i> 'China Snow' China Snow Chinese Fringe Tree, 2-2.5" Cal. Standard, B&B, Straight Trunk, Matched Specimens	100	EA
11	LM	1670	<i>Lagerstroemia x 'Muskogee'</i> Muskogee Crape Myrtle, 8-10', 3 to 5 Stems, B&B, Limbed to 3'	122	EA
12	BBC	1670	<i>Buddleia x 'Blue Chip'</i> PP# 19,991 Lo and Behold Blue Chip Butterfly Bush, 18-24", #3 Cont. Well Branched, 3' OC	80	EA
13	IL	1670	<i>Ilex x 'Liberty'</i> PP# 12009 Liberty Red Holly, 8,10', B&B, Heavy branched to ground, Matched specimens	72	EA
14	DVJ	1670	<i>Distylium x 'Vintage Jade'</i> PPAF Vintage Jade Distylium, 18-24", #3 Cont. Well Branched, 3' OC	260	EA
15	MC	1670	<i>Muhlenbergia capillaris</i> Pink Muhly Grass, #1 Cont. Fully Rooted into Cont., 3' OC	200	EA

Note: Zoysia Sod shall be installed at locations in the median designated by the Engineer in the field.

CONVENTIONAL SYMBOLS

County Line	-----
City or Town Line	-----
Exist. Right of Way Line Marker	-----▲-----
Prop. Right of Way Line Marker (By Others)	-----▲-----
Prop. Right of Way Line Marker (By Contract)	-----▲-----
Exist. Control of Access Line	-----○-----
Prop. Control of Access Line	-----○-----
Property Line	-----○-----
Easement Line	-----○-----
Slope Stake Line	-----○-----
Exist. Fence	-----○-----
Prop. Woven Wire Fence	-----○-----
Prop. Chain Link Fence	-----○-----
Exist. Road	-----○-----
Prop. Road	-----○-----
Guardrail	-----○-----
Survey Line	-----○-----
Denotes Line Equality	-----○-----
Bridge	-----○-----
Culvert	-----○-----
Railroad	-----○-----
Woods	-----○-----
Exist. Telephone Pole	-----○-----
Prop. Telephone Pole	-----○-----
Tower Pole and Line	-----○-----
Exist. Power Pole	-----○-----
Prop. Power Pole	-----○-----
Sanitary Sewer Line	-----○-----
Water Line	-----○-----
Gas Line	-----○-----
Picnic Shelter	-----○-----
Regeneration	-----○-----
Reforestation	-----○-----

INDEX OF L SHEETS:

1	Title, Description and Summary of Quantities
2	Planting Details
3	Planting Layout Details
4-20	Planting Plans

PREPARED BY: **CSM**
 PRELIMINARY DESIGN DATE: **Jan. 10, 2014**
 FINAL DESIGN DATE: **June 20, 2014**

Brawley School Road SR 1100 - Median

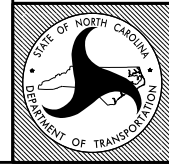

STATE OF
NORTH CAROLINA
DEPARTMENT OF TRANSPORTATION

LOCATION:	Median of Brawley School Road, SR 1100
TYPE of WORK:	Landscape Planting
COUNTY:	Iredell County

DIVISION
12

2004 American Standard for Nursery Stock
 2012 NCDOT STANDARD SPECIFICATIONS
 PREPARED IN THE OFFICE OF:
 NCDOT- ROADSIDE ENVIRONMENTAL UNIT
 LANDSCAPE DESIGN & DEVELOPMENT SECTION
 1557 MAIL SERVICE CENTER
 RALEIGH, NC 27699 919-733-2920

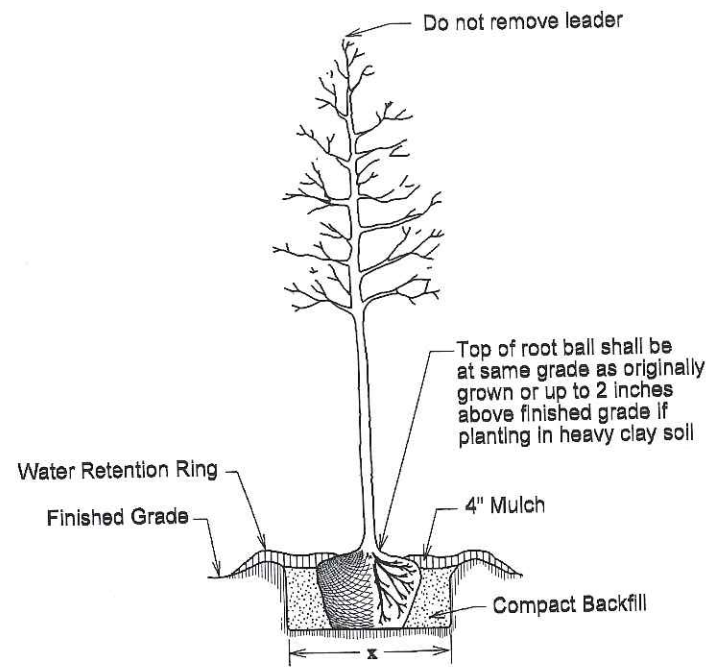

Tree or Shrub Planting Detail
(Level Ground)

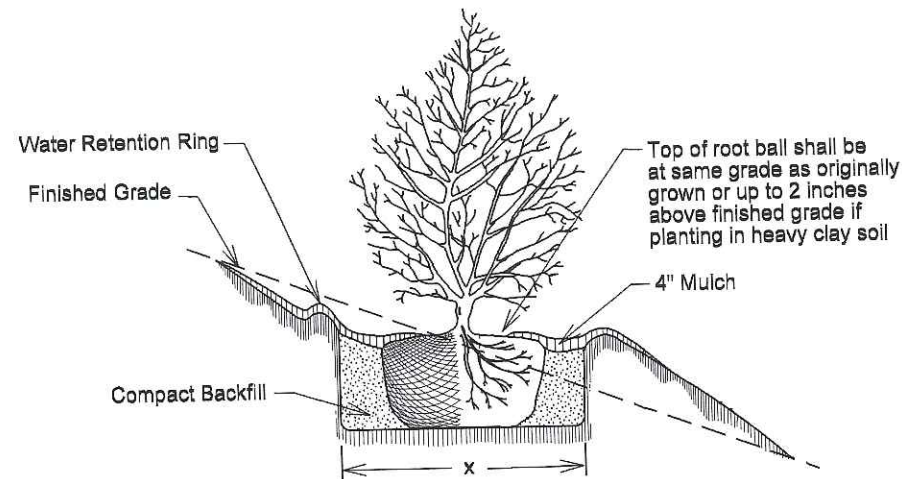

Tree or Shrub Planting Detail
(Sloping Ground)

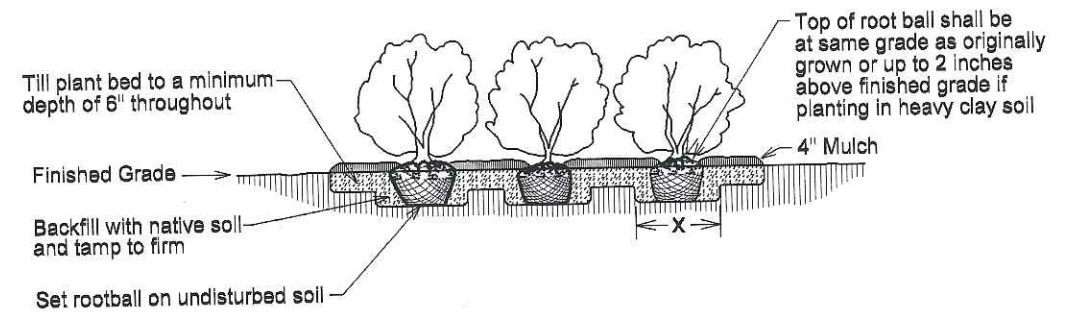

Bed Planting Detail

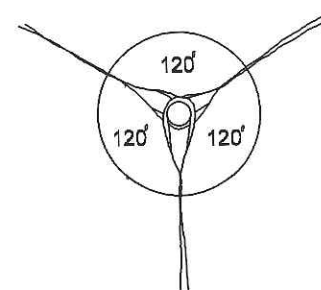

Guy Spacing Detail

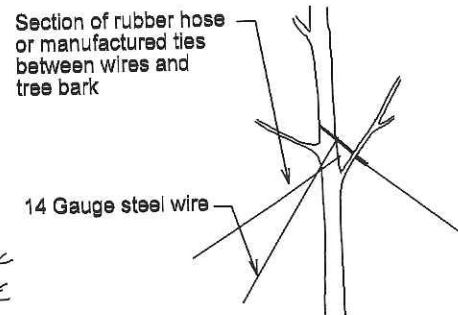

Guy Tying Detail

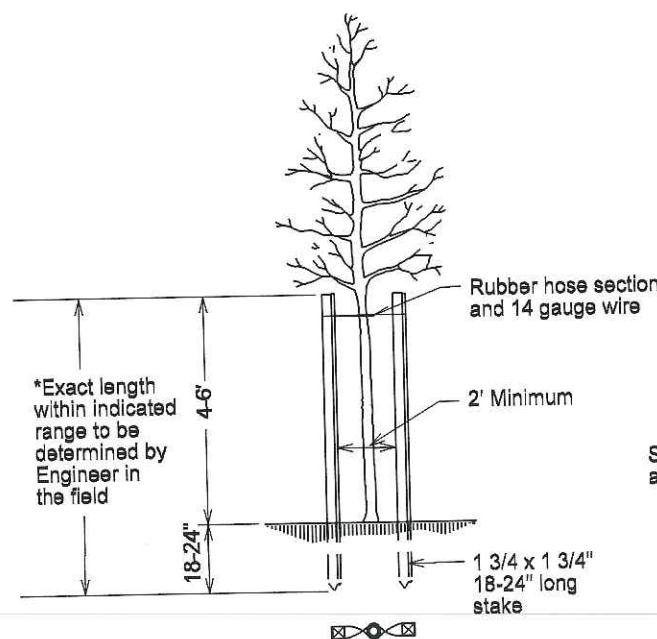

Staking Detail
(for trees 6' to 10')

* Utilize staking detail only if requested by the Engineer.

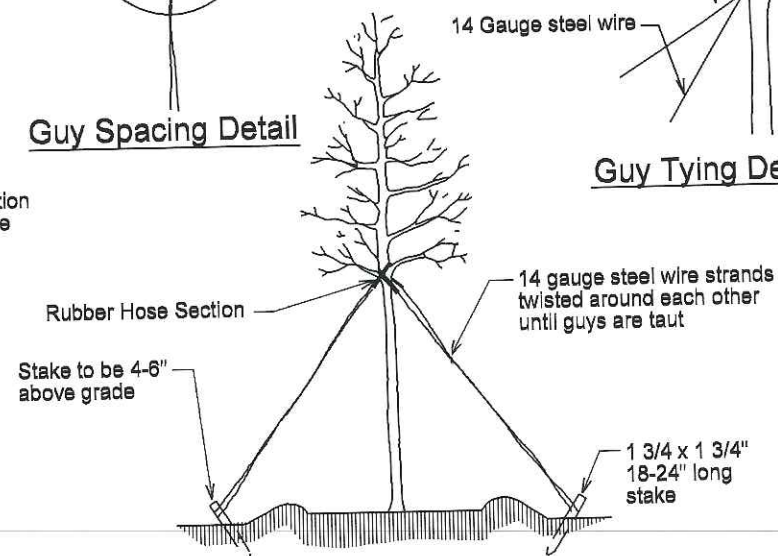

Tree Guying Detail
(for trees 10' or larger)

* Utilize guying detail only if requested by the Engineer.

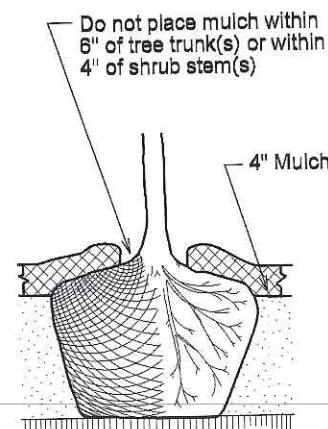

Mulch Detail

Planting Detail Notes:

- See Standard Specifications for Plant Bed preparation and herbicidal treatment
- Plant Hole:
X = 2 times the diameter of the container or the root ball. Depth of plant hole shall be equal to depth of root ball. Root ball shall be set on undisturbed soil and top of root ball shall be set at same grade as was grown.
- Fertilizer shall be applied at time of planting. Fertilizer shall be a slow release pellet or tablet. Formulation shall be approved by engineer in field. Rates shall be per manufacturer's recommendations and approved by engineer in field. Thoroughly mix with backfill, topsoil or scarified soil.
- Backfill plant hole with native soil unless soil is determined to be unacceptable. Remove rocks greater than 3 inches, foreign materials and construction debris from backfill material. If native soil cannot be used, use soil with properties similar to that in the area.
- Cut and remove wire basket and remove burlap around top of root ball to expose root collar before backfilling. Set root ball at grade or slightly above as directed by the Engineer depending on soil type at installation site. Do not place mulch within 6" of tree trunk or 4" of shrub trunk.
- When mulched bed is adjacent to guard rail run mulch to front edge of guardrail - see detail
- Any pruning necessary shall follow current standard arboricultural practices and International Society of Arboriculture recommendations
- Tree guying or staking materials manufactured specifically for this purpose may be substituted for the wire and staking materials shown in this detail. Any substitutions of material or method must be approved by the Engineer prior to installation.
- Do not attempt to straighten a tree that has been planted at an angle with the use of staking or guying. Dig tree and reset root ball to achieve an upright, plumb position.
- All staking and guying materials as well as plant material tags from the nursery shall be removed from the plants upon final acceptance of the project or at the end of the establishment period.



NCDOT - ROADSIDE ENVIRONMENTAL UNIT
LANDSCAPE DESIGN & DEVELOPMENT
1557 MAIL SERVICE CENTER RALEIGH NC 27699-1557
PH: 919-707-2920 FAX: 919-715-2554
HTTP://WWW.NCDOT.ORG/DOH/OPERATIONS/DP_CHIEF_ENG/ROADSIDE/

BRAWLEY SCHOOL ROAD MEDIAN
LANDSCAPE PLANTING
MOORESVILLE, IREDELL COUNTY



SHEET DESCRIPTION:

LANDSCAPE DEVELOPMENT
PLANTING DETAILS

PRELIMINARY DESIGN DATE: JAN. 10, 2014 FINAL DESIGN DATE: JUNE 20, 2014
PROJECT: MOORESVILLE - SR 1100
BRAWLEY SCHOOL ROAD MEDIAN
DIVISION AND COUNTY: DIVISION 12 - IREDELL COUNTY

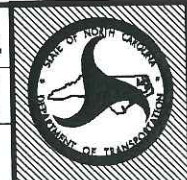

SHEET NO: 2
TOTAL SHEET NO: 20

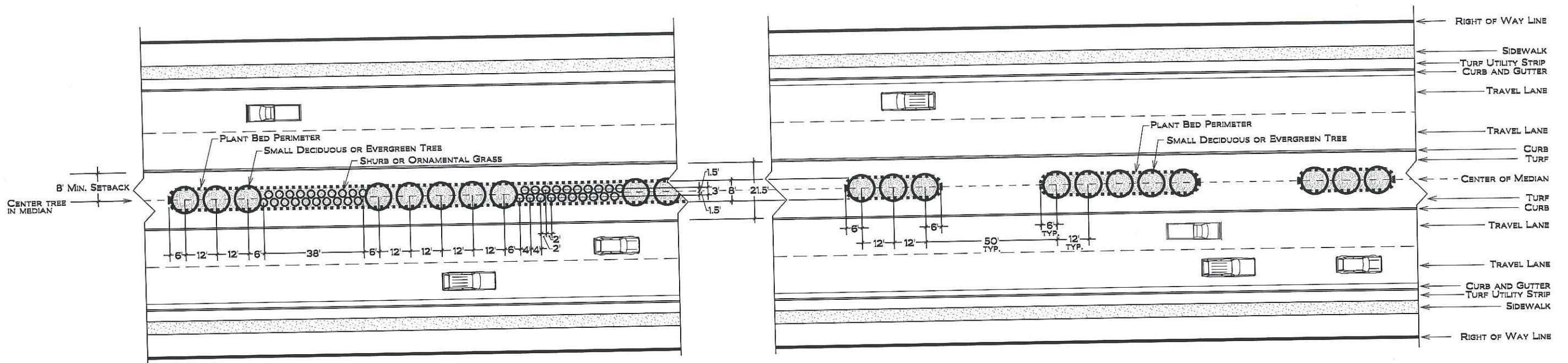

TYPICAL PLANT SPACING AND BED LAYOUT DETAIL - MEDIAN A, B, AND C

TYPICAL PLANT SPACING AND BED LAYOUT DETAIL - MEDIAN D THROUGH O

INCORPORATE SOIL AMENDMENT IN MEDIAN BEDS A, B AND C.

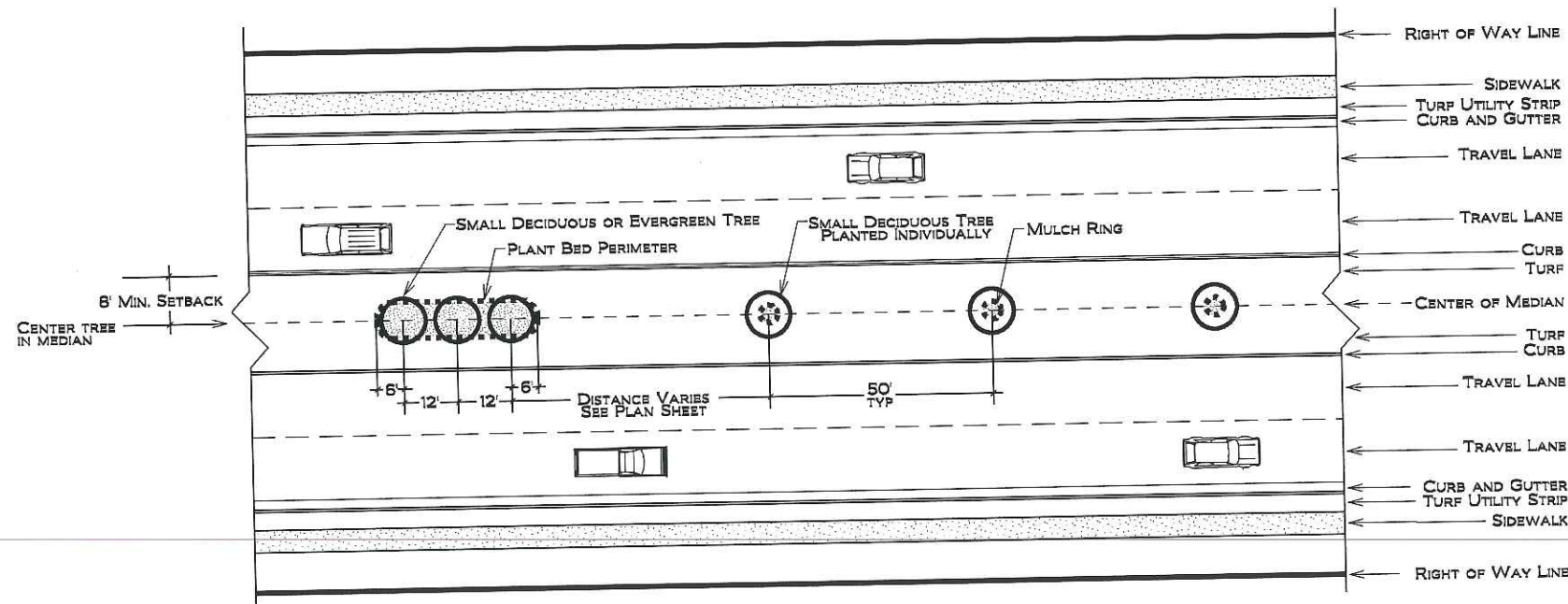

TYPICAL PLANT SPACING AND BED LAYOUT DETAIL - MEDIAN H AND N

NOT TO SCALE



NCDOT - ROADSIDE ENVIRONMENTAL UNIT
 LANDSCAPE DESIGN & DEVELOPMENT
 1557 MAIL SERVICE CENTER RALEIGH NC 27699-1557
 PH: 919-707-2920 FAX: 919-715-2554
[HTTP://WWW.NCDOT.ORG/DOH/OPERATIONS/DP_CHIEF_ENG/ROADSIDE/](http://www.ncdot.org/DOH/OPERATIONS/DP_CHIEF_ENG/ROADSIDE/)

BRAWLEY SCHOOL ROAD MEDIAN
 LANDSCAPE PLANTING
 MOORESVILLE, IREDELL COUNTY



SHEET DESCRIPTION:
 LANDSCAPE DEVELOPMENT
 PLANTING LAYOUT DETAILS

PRELIMINARY DESIGN DATE: JAN. 10, 2014 FINAL DESIGN DATE: JUNE 20, 2014
 PROJECT: MOORESVILLE - SR 1100
 BRAWLEY SCHOOL ROAD MEDIAN
 DIVISION AND COUNTY: DIVISION 12 - IREDELL COUNTY

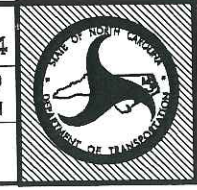

SHEET NO: 3
 TOTAL SHEET NO: 20

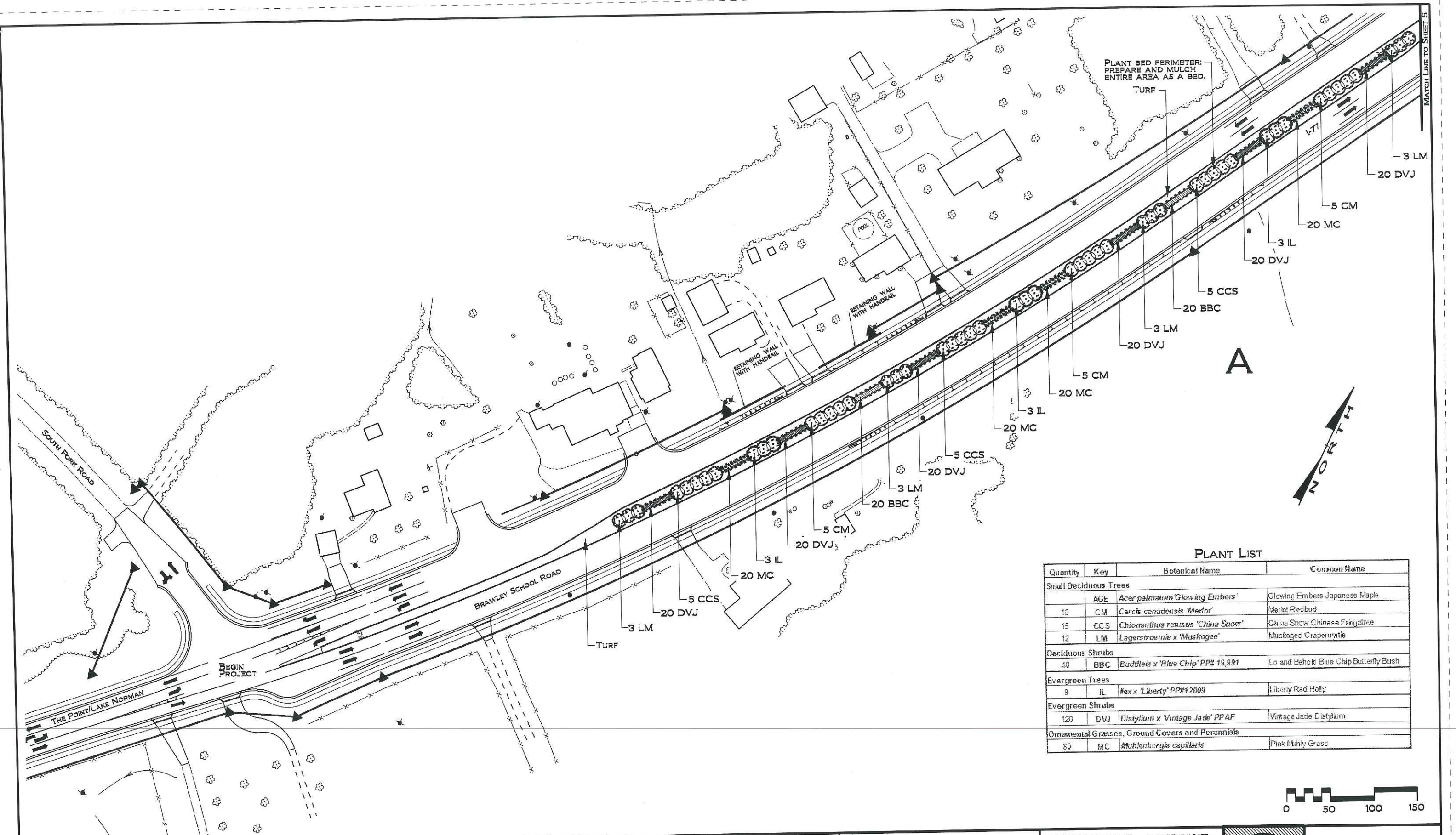

PLANT LIST

Quantity	Key	Botanical Name	Common Name
Small Deciduous Trees			
	AGE	<i>Acer palmatum</i> 'Glowing Embers'	Glowing Embers Japanese Maple
15	CM	<i>Cercis canadensis</i> 'Merlot'	Merlot Redbud
15	CCS	<i>Chionanthus retusus</i> 'China Snow'	China Snow Chinese Fringetree
12	LM	<i>Lagerstroemia</i> x 'Muskogee'	Muskogee Crapemyrtle
Deciduous Shrubs			
40	BBC	<i>Buddleia</i> x 'Blue Chip' PP# 19,991	Lo and Behold Blue Chip Butterfly Bush
Evergreen Trees			
9	IL	<i>Ilex</i> x 'Liberty' PP#1 2009	Liberty Red Holly
Evergreen Shrubs			
120	DVJ	<i>Distylium</i> x 'Vintage Jade' PPAF	Vintage Jade Distylium
Ornamental Grasses, Ground Covers and Perennials			
80	MC	<i>Muhlenbergia capillaris</i>	Pink Muhly Grass



NCDOT - ROADSIDE ENVIRONMENTAL UNIT
 LANDSCAPE DESIGN & DEVELOPMENT
 1557 MAIL SERVICE CENTER RALEIGH NC 27699-1557
 PH: 919-707-2920 FAX: 919-715-2554
[HTTP://WWW.NCDOT.ORG/DOH/OPERATIONS/DP_CHIEF_ENG/ROADSIDE/](http://www.ncdot.org/doh/operations/dp_chief_eng/roadside/)

**BRAWLEY SCHOOL ROAD MEDIAN
 LANDSCAPE PLANTING
 MOORESVILLE, IREDELL COUNTY**

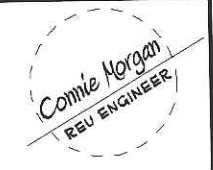

LANDSCAPE DEVELOPMENT
PLANTING PLAN
 MEDIAN A

PRELIMINARY DESIGN DATE: JAN. 10, 2014 FINAL DESIGN DATE: JUNE 20, 2014
 PROJECT: MOORESVILLE - SR 1100
 BRAWLEY SCHOOL ROAD MEDIAN
 DIVISION AND COUNTY: DIVISION 12 - IREDELL COUNTY



SHEET NO: 4
 TOTAL SHEET NO: 20

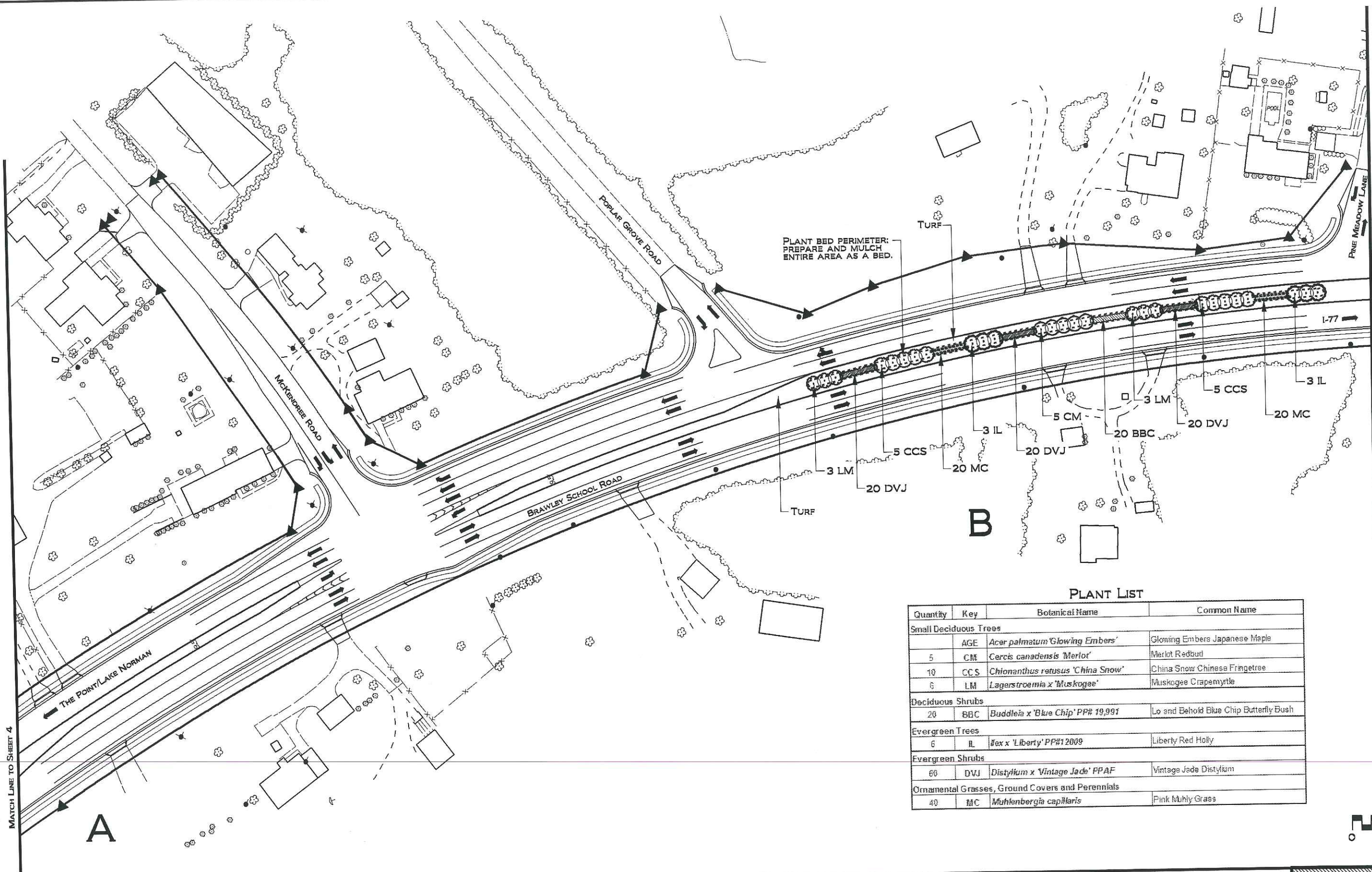

PLANT LIST

Quantity	Key	Botanical Name	Common Name
Small Deciduous Trees			
	AGE	<i>Acer palmatum</i> 'Glowing Embers'	Glowing Embers Japanese Maple
5	CM	<i>Cercis canadensis</i> 'Merlot'	Merlot Redbud
10	CCS	<i>Chionanthus retusus</i> 'China Snow'	China Snow Chinese Fringetree
6	LM	<i>Lagerstroemia</i> x 'Muskogee'	Muskogee Crape myrtle
Deciduous Shrubs			
20	BBC	<i>Buddleia</i> x 'Blue Chip' PPR 19,991	Lo and Behold Blue Chip Butterfly Bush
Evergreen Trees			
6	IL	<i>Ilex</i> x 'Liberty' PPR 12,009	Liberty Red Holly
Evergreen Shrubs			
60	DVJ	<i>Distylium</i> x 'Vintage Jade' PPAF	Vintage Jade Distylium
Ornamental Grasses, Ground Covers and Perennials			
40	MC	<i>Muhlenbergia capillaris</i>	Pink Muhly Grass



NCDOT - ROADSIDE ENVIRONMENTAL UNIT
 LANDSCAPE DESIGN & DEVELOPMENT
 1557 MAIL SERVICE CENTER RALEIGH NC 27699-1557
 PH: 919-707-2920 FAX: 919-715-2554
[HTTP://WWW.NCDOT.ORG/DOH/OPERATIONS/DP_CHIEF_ENG/ROADSIDE/](http://www.ncdot.org/DOH/OPERATIONS/DP_CHIEF_ENG/ROADSIDE/)

BRAWLEY SCHOOL ROAD MEDIAN
 LANDSCAPE PLANTING
 MOORESVILLE, IREDELL COUNTY

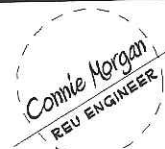

LANDSCAPE DEVELOPMENT
 PLANTING PLAN
 MEDIAN B

PRELIMINARY DESIGN DATE: JAN. 10, 2014 FINAL DESIGN DATE: JUNE 20, 2014
 PROJECT: MOORESVILLE - SR 1100
 BRAWLEY SCHOOL ROAD MEDIAN
 DIVISION AND COUNTY: DIVISION 12 - IREDELL COUNTY



SHEET NO: 5
 TOTAL SHEET NO: 20

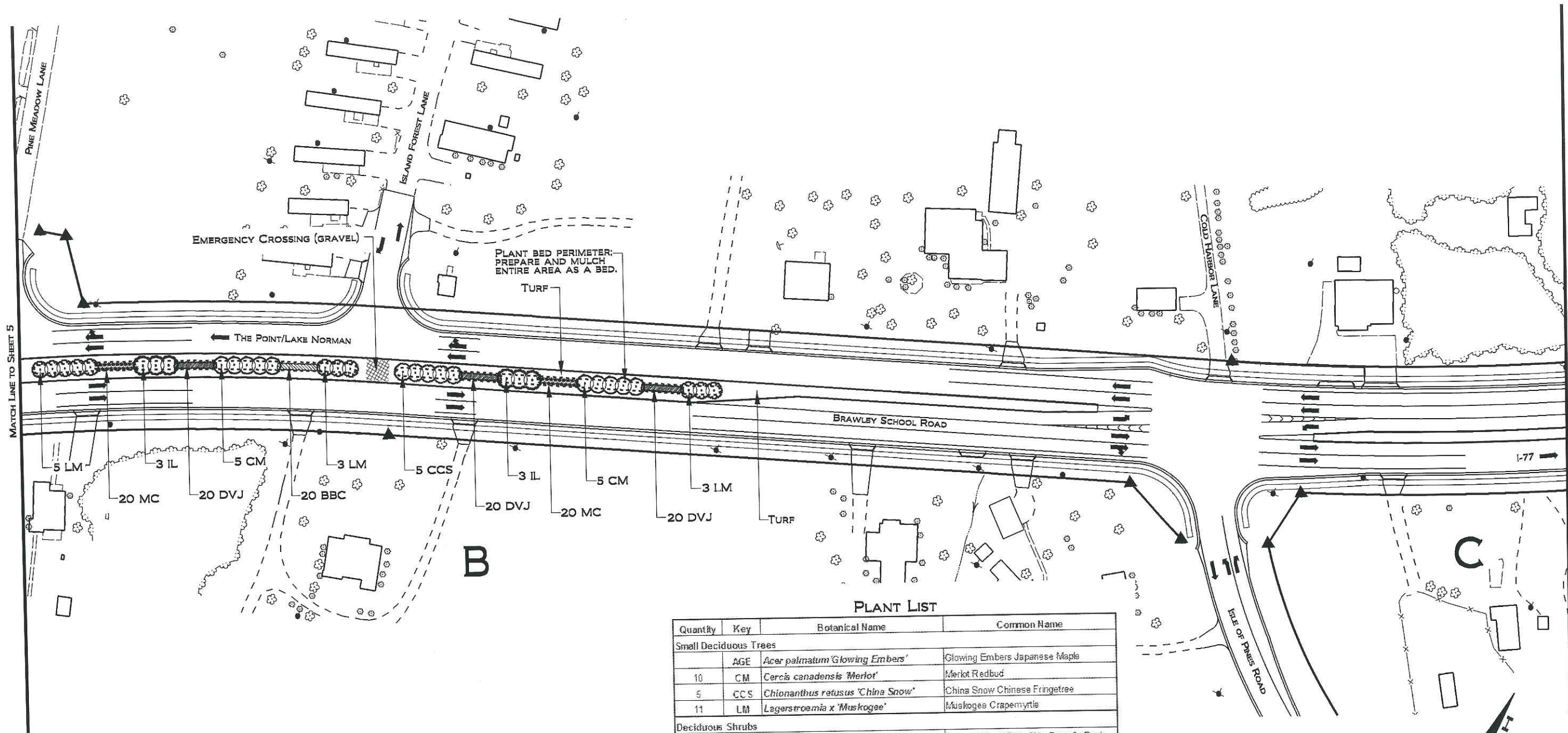

PLANT LIST

Quantity	Key	Botanical Name	Common Name
Small Deciduous Trees			
	AGE	<i>Acer palmatum</i> 'Glowing Embers'	Glowing Embers Japanese Maple
10	CM	<i>Cercis canadensis</i> 'Merlot'	Merlot Redbud
5	CCS	<i>Chionanthus retusus</i> 'China Snow'	China Snow Chinese Fringetree
11	LM	<i>Lagerstroemia x 'Muskogee'</i>	Muskogee Crape myrtle
Deciduous Shrubs			
20	BBC	<i>Buddleia x 'Blue Chip'</i> PP# 19,991	Lo and Behold Blue Chip Butterfly Bush
Evergreen Trees			
6	IL	<i>Ilex x 'Liberty'</i> PP#12003	Liberty Red Holly
Evergreen Shrubs			
60	DVJ	<i>Distylium x 'Vintage Jade'</i> PPAF	Vintage Jade Distylium
Ornamental Grasses, Ground Covers and Perennials			
40	MC	<i>Muhlenbergia capillaris</i>	Pink Muhly Grass

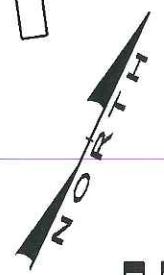

NCDOT - ROADSIDE ENVIRONMENTAL UNIT
 LANDSCAPE DESIGN & DEVELOPMENT
 1557 MAIL SERVICE CENTER RALEIGH NC 27699-1557
 PH: 919-707-2920 FAX: 919-715-2554
[HTTP://WWW.NCDOT.ORG/DOH/OPERATIONS/DP_CHIEF_ENG/ROADSIDE/](http://www.ncdot.org/doh/operations/dp_chief_eng/roadside/)

**BRAWLEY SCHOOL ROAD MEDIAN
 LANDSCAPE PLANTING
 MOORESVILLE, IREDELL COUNTY**

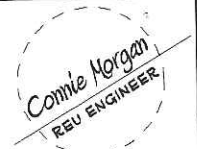

LANDSCAPE DEVELOPMENT
PLANTING PLAN
 MEDIAN B

PRELIMINARY DESIGN DATE: JAN. 10, 2014 FINAL DESIGN DATE: JUNE 20, 2014
 PROJECT: MOORESVILLE - SR 1100
 BRAWLEY SCHOOL ROAD MEDIAN
 DIVISION AND COUNTY: DIVISION 12 - IREDELL COUNTY



SHEET NO: 6
 TOTAL SHEET NO: 20

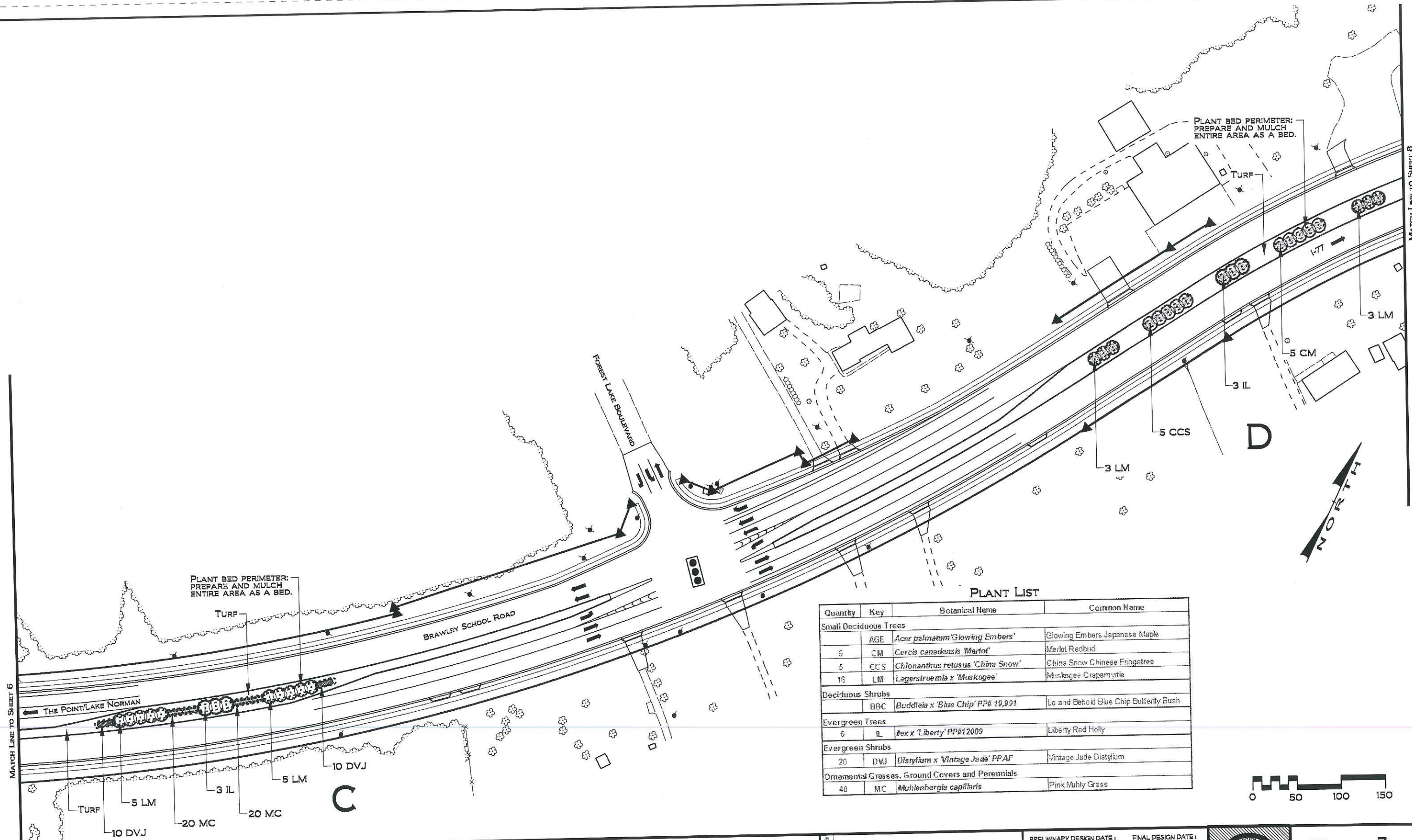

PLANT LIST

Quantity	Key	Botanical Name	Common Name
Small Deciduous Trees			
	AGE	<i>Acer palmatum</i> 'Glowing Embers'	Glowing Embers Japanese Maple
5	CM	<i>Cercis canadensis</i> 'Merlot'	Merlot Redbud
5	CCS	<i>Chionanthus retusus</i> 'China Snow'	China Snow Chinese Fringetree
16	LM	<i>Lagerstroemia x 'Muskogee'</i>	Muskogee Crapemyrtle
Deciduous Shrubs			
	BBC	<i>Buddleia x 'Blue Chip'</i> PP# 19,991	Lo and Behold Blue Chip Butterfly Bush
Evergreen Trees			
6	IL	#ex x 'Liberty' PP#12009	Liberty Red Holly
Evergreen Shrubs			
20	DVJ	<i>Distylium x 'Vintage Jade'</i> PPAF	Vintage Jade Distylium
Ornamental Grasses, Ground Covers and Perennials			
40	MC	<i>Muhlenbergia capillaris</i>	Pink Muhly Grass

MATCH LINE TO SHEET 6

MATCH LINE TO SHEET 8



NCDOT - ROADSIDE ENVIRONMENTAL UNIT
 LANDSCAPE DESIGN & DEVELOPMENT
 1557 MAIL SERVICE CENTER RALEIGH NC 27699-1557
 PH: 919-707-2920 FAX: 919-715-2554
[HTTP://WWW.NCDOT.ORG/DOH/OPERATIONS/DP_CHIEF_ENG/ROADSIDE/](http://www.ncdot.org/DOH/OPERATIONS/DP_CHIEF_ENG/ROADSIDE/)

**BRAWLEY SCHOOL ROAD MEDIAN
 LANDSCAPE PLANTING
 MOORESVILLE, IREDELL COUNTY**



LANDSCAPE DEVELOPMENT
PLANTING PLAN
 MEDIANS C AND D

PRELIMINARY DESIGN DATE: JAN. 10, 2014 FINAL DESIGN DATE: JUNE 20, 2014
 PROJECT: MOORESVILLE - SR 1100
 BRAWLEY SCHOOL ROAD MEDIAN
 DIVISION AND COUNTY: DIVISION 12 - IREDELL COUNTY



SHEET NO: 7
 TOTAL SHEET NO: 20

MATCH LINE TO SHEET 7

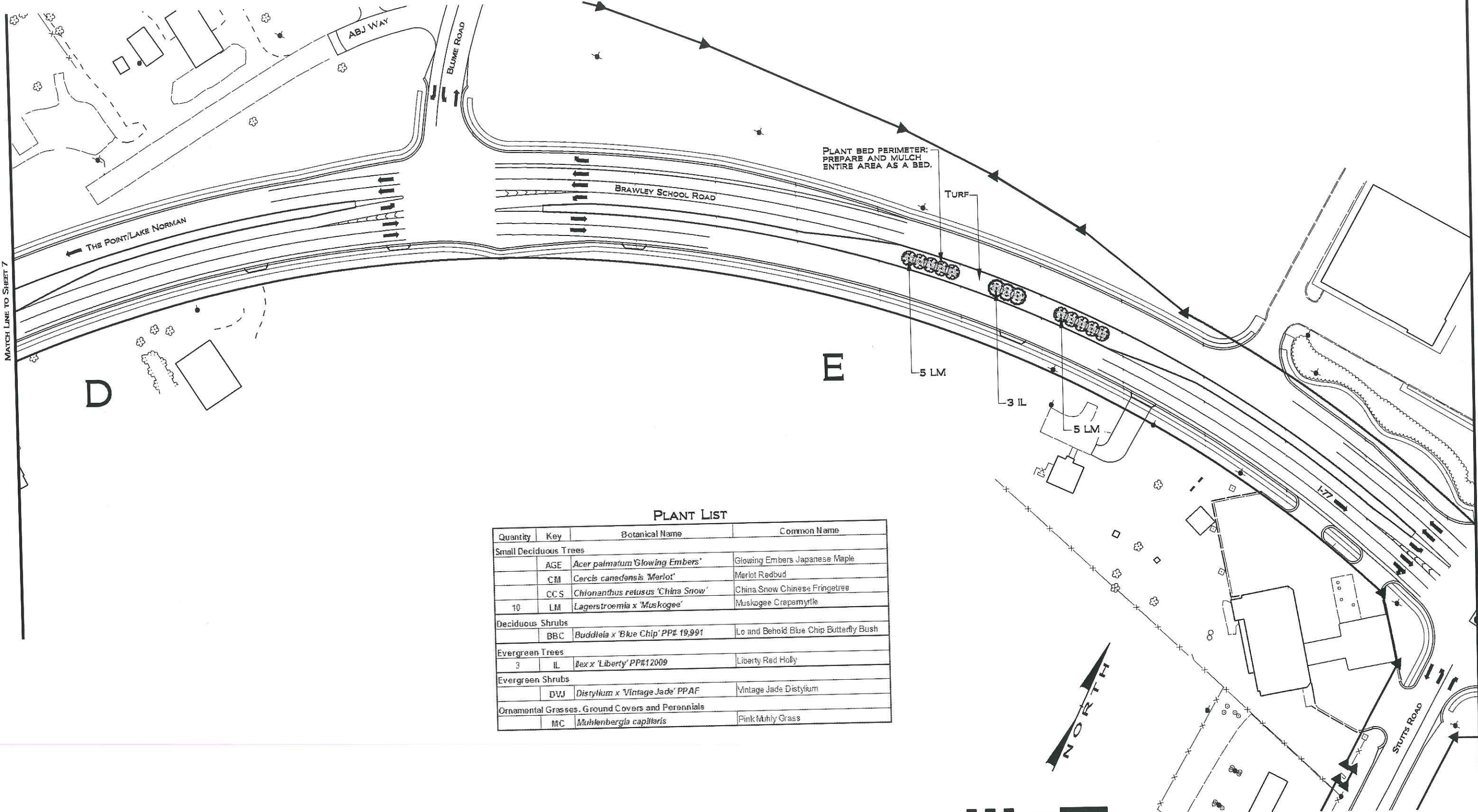

PLANT LIST

Quantity	Key	Botanical Name	Common Name
Small Deciduous Trees			
	AGE	<i>Acer palmatum</i> 'Glowing Embers'	Glowing Embers Japanese Maple
	CM	<i>Cercis canadensis</i> 'Merlot'	Merlot Redbud
	CCS	<i>Chionanthus retusus</i> 'China Snow'	China Snow Chinese Fringetree
10	LM	<i>Lagerstroemia x 'Muskogee'</i>	Muskogee Crepamyrtle
Deciduous Shrubs			
	BBC	<i>Buddleia x 'Blue Chip'</i> PP# 19,991	Lo and Behold Blue Chip Butterfly Bush
Evergreen Trees			
3	IL	<i>Ilex x 'Liberty'</i> PP#12009	Liberty Red Holly
Evergreen Shrubs			
	DVJ	<i>Distylium x 'Vintage Jade'</i> PPAF	Vintage Jade Distylium
Ornamental Grasses, Ground Covers and Perennials			
	MC	<i>Muhlenbergia capillaris</i>	Pink Muhly Grass

MATCH LINE TO SHEET 9



NCDOT - ROADSIDE ENVIRONMENTAL UNIT
 LANDSCAPE DESIGN & DEVELOPMENT
 1557 MAIL SERVICE CENTER RALEIGH NC 27699-1557
 PH: 919-707-2920 FAX: 919-715-2554
[HTTP://WWW.NCDOT.ORG/DOH/OPERATIONS/DP_CHIEF_ENG/ROADSIDE/](http://www.ncdot.org/doh/operations/dp_chief_eng/roadside/)

BRAWLEY SCHOOL ROAD MEDIAN
 LANDSCAPE PLANTING
 MOORESVILLE, IREDELL COUNTY



LANDSCAPE DEVELOPMENT
 PLANTING PLAN
 MEDIAN E

PRELIMINARY DESIGN DATE: JAN. 10, 2014
 FINAL DESIGN DATE: JUNE 20, 2014
 PROJECT: MOORESVILLE - SR 1100
 BRAWLEY SCHOOL ROAD MEDIAN
 DIVISION AND COUNTY: DIVISION 12 - IREDELL COUNTY



SHEET NO: 8
 TOTAL SHEET NO: 20

MATCH LINE TO SHEET 8

PLANT LIST

Quantity	Key	Botanical Name	Common Name
Small Deciduous Trees			
	AGE	<i>Acer palmatum</i> 'Glowing Embers'	Glowing Embers Japanese Maple
5	CM	<i>Cercis canadensis</i> 'Merlot'	Merlot Redbud
5	CCS	<i>Chionanthus retusus</i> 'China Snow'	China Snow Chinese Fringetree
6	LM	<i>Lagerstroemia</i> x 'Muskogee'	Muskogee Crapemyrtle
Deciduous Shrubs			
	BBC	<i>Buddleia</i> x 'Blue Chip' PP# 19,991	Lo and Behold Blue Chip Butterfly Bush
Evergreen Trees			
3	IL	<i>Ilex</i> x 'Liberty' PP#12009	Liberty Red Holly
Evergreen Shrubs			
	DVJ	<i>Distylium</i> x 'Vintage Jade' PPAF	Vintage Jade Distylium
Ornamental Grasses, Ground Covers and Perennials			
	MC	<i>Muhlenbergia capillaris</i>	Pink Muhly Grass

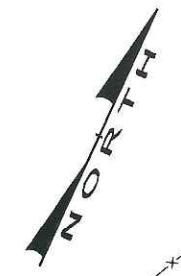

PLANT BED PERIMETER;
PREPARE AND MULCH
ENTIRE AREA AS A BED.

TURF

BRAWLEY SCHOOL ROAD

L-77

ESQUIRE DRIVE

F

3 LM

5 CCS

3 IL

5 CM

3 LM



MATCH LINE TO SHEET 10



NCDOT - ROADSIDE ENVIRONMENTAL UNIT
 LANDSCAPE DESIGN & DEVELOPMENT
 1557 MAIL SERVICE CENTER RALEIGH NC 27699-1557
 PH: 919-707-2920 FAX: 919-715-2554
[HTTP://WWW.NCDOT.ORG/DOH/OPERATIONS/DP_CHIEF_ENG/ROADSIDE/](http://www.ncdot.org/DOH/OPERATIONS/DP_CHIEF_ENG/ROADSIDE/)

BRAWLEY SCHOOL ROAD MEDIAN
 LANDSCAPE PLANTING
 MOORESVILLE, IREDELL COUNTY

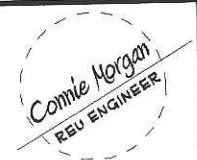

LANDSCAPE DEVELOPMENT
 PLANTING PLAN
 MEDIAN F

PRELIMINARY DESIGN DATE: JAN. 10, 2014
 FINAL DESIGN DATE: JUNE 20, 2014
 PROJECT: MOORESVILLE - SR 1100
 BRAWLEY SCHOOL ROAD MEDIAN
 DIVISION AND COUNTY: DIVISION 12 - IREDELL COUNTY

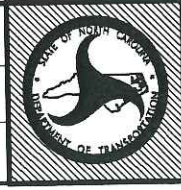

SHEET NO: 9
 TOTAL SHEET NO: 20

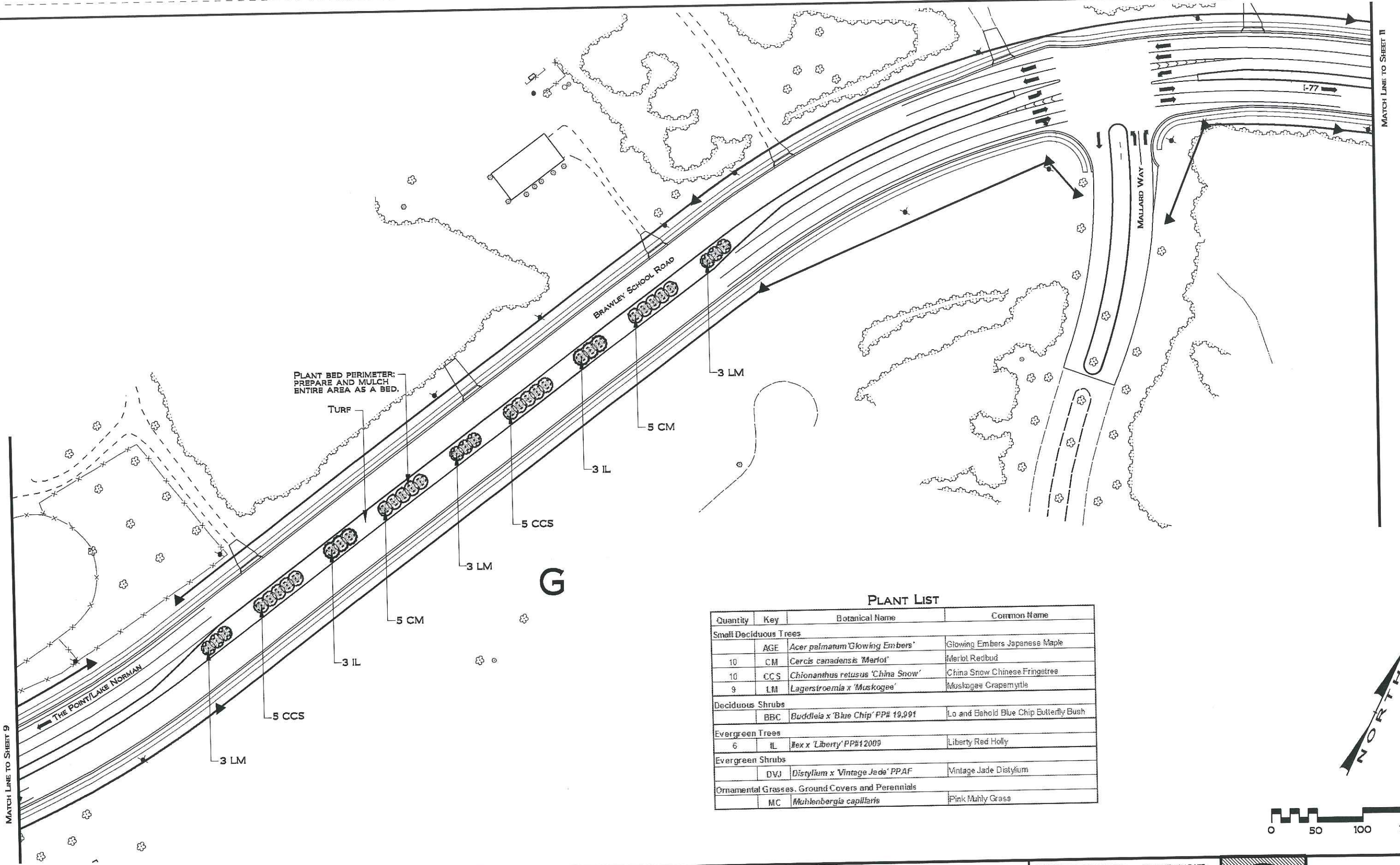

PLANT LIST

Quantity	Key	Botanical Name	Common Name
Small Deciduous Trees			
	AGE	<i>Acer palmatum</i> 'Glowing Embers'	Glowing Embers Japanese Maple
10	CM	<i>Cercis canadensis</i> 'Merlot'	Merlot Redbud
10	CCS	<i>Chionanthus retusus</i> 'China Snow'	China Snow Chinese Fringetree
9	LM	<i>Lagerstroemia x 'Muskogee'</i>	Muskogee Crape myrtle
Deciduous Shrubs			
	BBC	<i>Buddleia x 'Blue Chip'</i> PP# 19,991	Lo and Behold Blue Chip Butterfly Bush
Evergreen Trees			
6	IL	<i>Ilex x 'Liberty'</i> PP#12089	Liberty Red Holly
Evergreen Shrubs			
	DVJ	<i>Distylium x 'Vintage Jade'</i> PPAF	Vintage Jade Distylium
Ornamental Grasses, Ground Covers and Perennials			
	MC	<i>Muhlenbergia capillaris</i>	Pink Muhly Grass

G



NCDOT - ROADSIDE ENVIRONMENTAL UNIT
 LANDSCAPE DESIGN & DEVELOPMENT
 1557 MAIL SERVICE CENTER RALEIGH NC 27699-1557
 PH: 919-707-2920 FAX: 919-715-2554
[HTTP://WWW.NCDOT.ORG/DOH/OPERATIONS/DP_CHIEF_ENG/ROADSIDE/](http://www.ncdot.org/doh/operations/dp_chief_eng/roadside/)

**BRAWLEY SCHOOL ROAD MEDIAN
 LANDSCAPE PLANTING
 MOORESVILLE, IREDELL COUNTY**

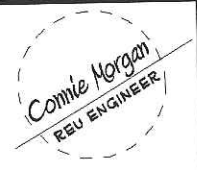

LANDSCAPE DEVELOPMENT
PLANTING PLAN
 MEDIAN G

PRELIMINARY DESIGN DATE: JAN. 10, 2014 FINAL DESIGN DATE: JUNE 20, 2014
 PROJECT: MOORESVILLE - SR 1100
 BRAWLEY SCHOOL ROAD MEDIAN
 DIVISION AND COUNTY: DIVISION 12 - IREDELL COUNTY



SHEET NO: 10
 TOTAL SHEET NO: 20

PLANT LIST

Quantity	Key	Botanical Name	Common Name
Small Deciduous Trees			
8	AGE	<i>Acer palmatum</i> 'Glowing Embers'	Glowing Embers Japanese Maple
10	CM	<i>Cercis canadensis</i> 'Merlot'	Merlot Redbud
10	CCS	<i>Chionanthus retusus</i> 'China Snow'	China Snow Chinese Fringetree
12	LM	<i>Lagerstroemia</i> x 'Muskogee'	Muskogee Crapemyrtle
Deciduous Shrubs			
	BBC	<i>Buddleia</i> x 'Blue Chip' PP# 19,991	Lo and Behold Blue Chip Butterfly Bush
Evergreen Trees			
6	IL	<i>Ilex</i> x 'Liberty' PP# 12,009	Liberty Red Holly
Evergreen Shrubs			
	DVJ	<i>Distylium</i> x 'Vintage Jade' PPAF	Vintage Jade Distylium
Ornamental Grasses, Ground Covers and Perennials			
	MC	<i>Muhlenbergia capillaris</i>	Pink Muhly Grass

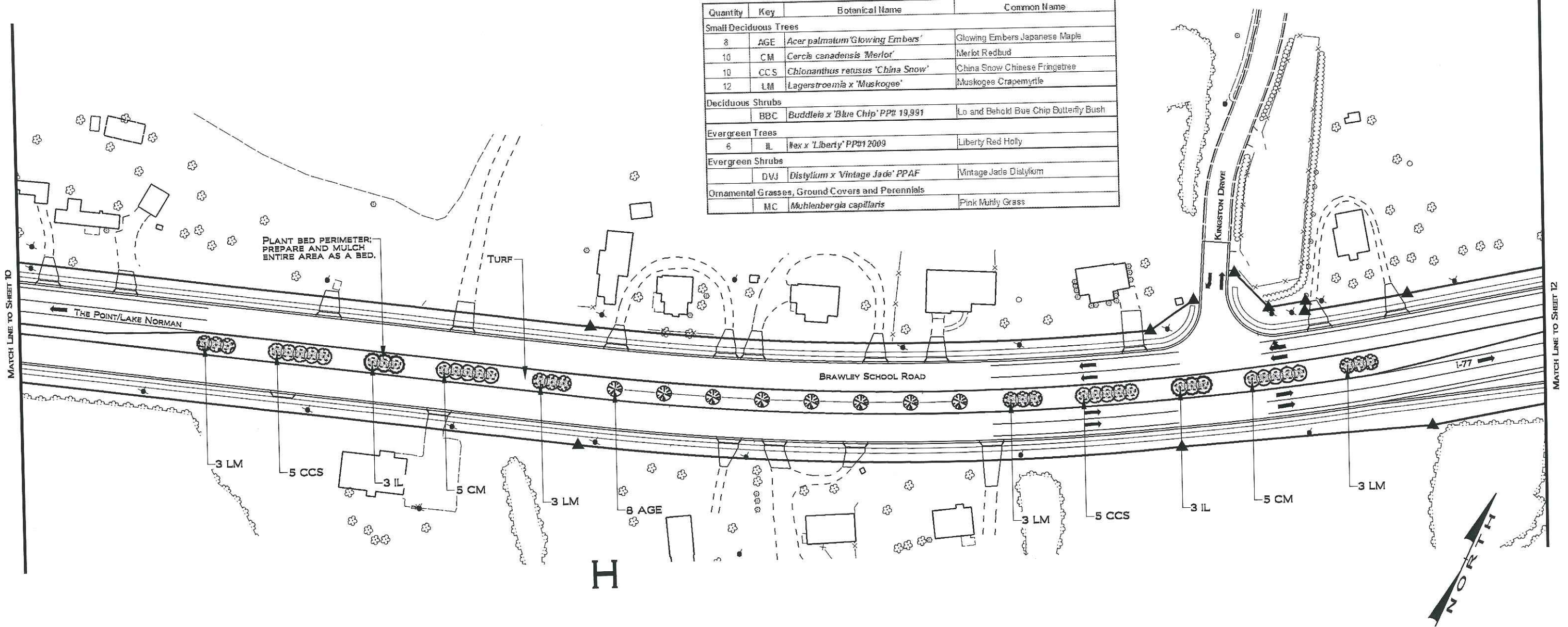

NCDOT - ROADSIDE ENVIRONMENTAL UNIT
 LANDSCAPE DESIGN & DEVELOPMENT
 1557 MAIL SERVICE CENTER RALEIGH NC 27699-1557
 PH: 919-707-2920 FAX: 919-715-2554
[HTTP://WWW.NCDOT.ORG/DOH/OPERATIONS/DP_CHIEF_ENG/ROADSIDE/](http://www.ncdot.org/doh/operations/dp_chief_eng/roadside/)

**BRAWLEY SCHOOL ROAD MEDIAN
 LANDSCAPE PLANTING
 MOORESVILLE, IREDELL COUNTY**

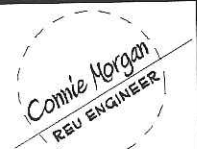

LANDSCAPE DEVELOPMENT
PLANTING PLAN
 MEDIAN H

PRELIMINARY DESIGN DATE: JAN. 10, 2014 FINAL DESIGN DATE: JUNE 20, 2014
 PROJECT: MOORESVILLE - SR 1100
 BRAWLEY SCHOOL ROAD MEDIAN
 DIVISION AND COUNTY: DIVISION 12 - IREDELL COUNTY



SHEET NO: 11
 TOTAL SHEET NO: 20

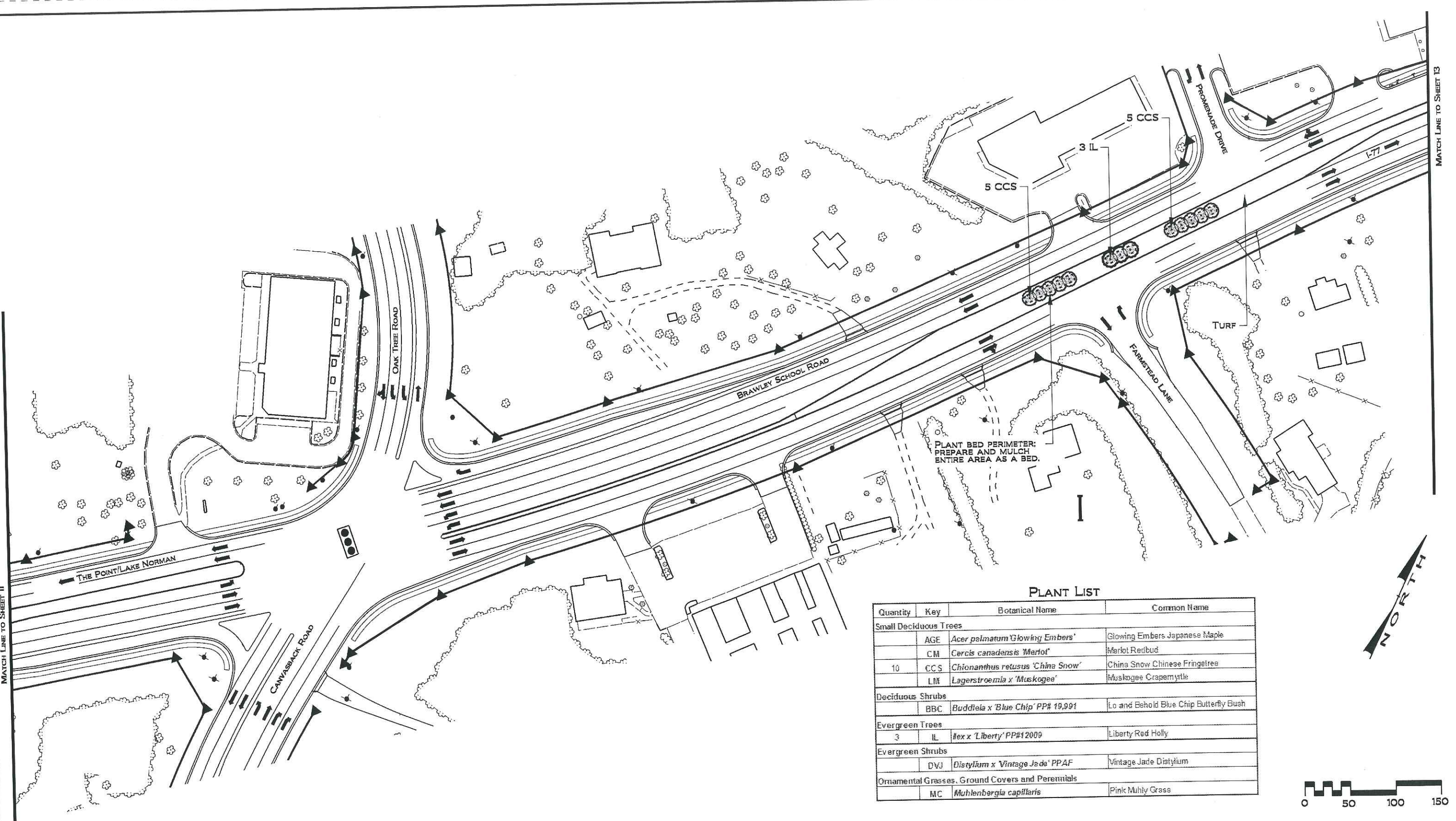

PLANT LIST

Quantity	Key	Botanical Name	Common Name
Small Deciduous Trees			
	AGE	<i>Acer palmatum</i> 'Glowing Embers'	Glowing Embers Japanese Maple
	CM	<i>Cercis canadensis</i> 'Merlot'	Merlot Redbud
10	CCS	<i>Chionanthus retusus</i> 'China Snow'	China Snow Chinese Fringetree
	LM	<i>Lagerstroemia</i> x 'Muskogee'	Muskogee Crapemyrtle
Deciduous Shrubs			
	BBC	<i>Buddleia</i> x 'Blue Chip' PP# 19,991	Lo and Behold Blue Chip Butterfly Bush
Evergreen Trees			
3	IL	#ex x 'Liberty' PP#12009	Liberty Red Holly
Evergreen Shrubs			
	DVJ	<i>Distylium</i> x 'Vintage Jade' PPAF	Vintage Jade Distylium
Ornamental Grasses, Ground Covers and Perennials			
	MC	<i>Muhlenbergia capillaris</i>	Pink Muhly Grass

MATCH LINE TO SHEET 11

MATCH LINE TO SHEET 13

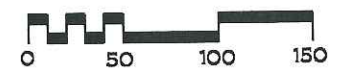
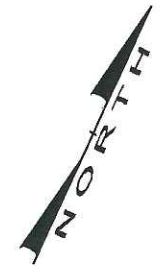

**NCDOT - ROADSIDE ENVIRONMENTAL UNIT
LANDSCAPE DESIGN & DEVELOPMENT**
1557 MAIL SERVICE CENTER RALEIGH NC 27699-1557
PH: 919-707-2920 FAX: 919-715-2554
[HTTP://WWW.NCDOT.ORG/DOH/OPERATIONS/DP_CHIEF_ENG/ROADSIDE/](http://www.ncdot.org/DOH/OPERATIONS/DP_CHIEF_ENG/ROADSIDE/)

**BRAWLEY SCHOOL ROAD MEDIAN
LANDSCAPE PLANTING
MOORESVILLE, IREDELL COUNTY**

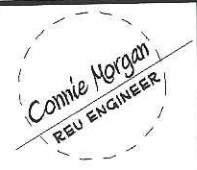

LANDSCAPE DEVELOPMENT
PLANTING PLAN
MEDIAN I

PRELIMINARY DESIGN DATE: JAN. 10, 2014
FINAL DESIGN DATE: JUNE 20, 2014
PROJECT: MOORESVILLE - SR 1100
BRAWLEY SCHOOL ROAD MEDIAN
DIVISION AND COUNTY: DIVISION 12 - IREDELL COUNTY

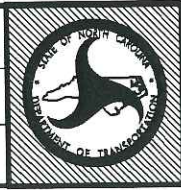

SHEET NO: 12
TOTAL SHEET NO: 20

PLANT LIST

Quantity	Key	Botanical Name	Common Name
Small Deciduous Trees			
	AGE	<i>Acer palmatum</i> 'Glowing Embers'	Glowing Embers Japanese Maple
10	CM	<i>Cercis canadensis</i> 'Merlot'	Merlot Redbud
	CCS	<i>Chionanthus retusus</i> 'China Snow'	China Snow Chinese Fringetree
	LM	<i>Lagerstroemia x 'Muskogee'</i>	Muskogee Crapemyrtle
Deciduous Shrubs			
	BBC	<i>Buddleia x 'Blue Chip'</i> PP# 19,991	Lo and Behold Blue Chip Butterfly Bush
Evergreen Trees			
3	IL	<i>Ilex</i> 'Liberty' PP#12009	Liberty Red Holly
Evergreen Shrubs			
	DVJ	<i>Distylium x 'Vintage Jade'</i> PPAF	Vintage Jade Distylium
Ornamental Grasses, Ground Covers and Perennials			
	MC	<i>Muhlenbergia capillaris</i>	Pink Muhly Grass

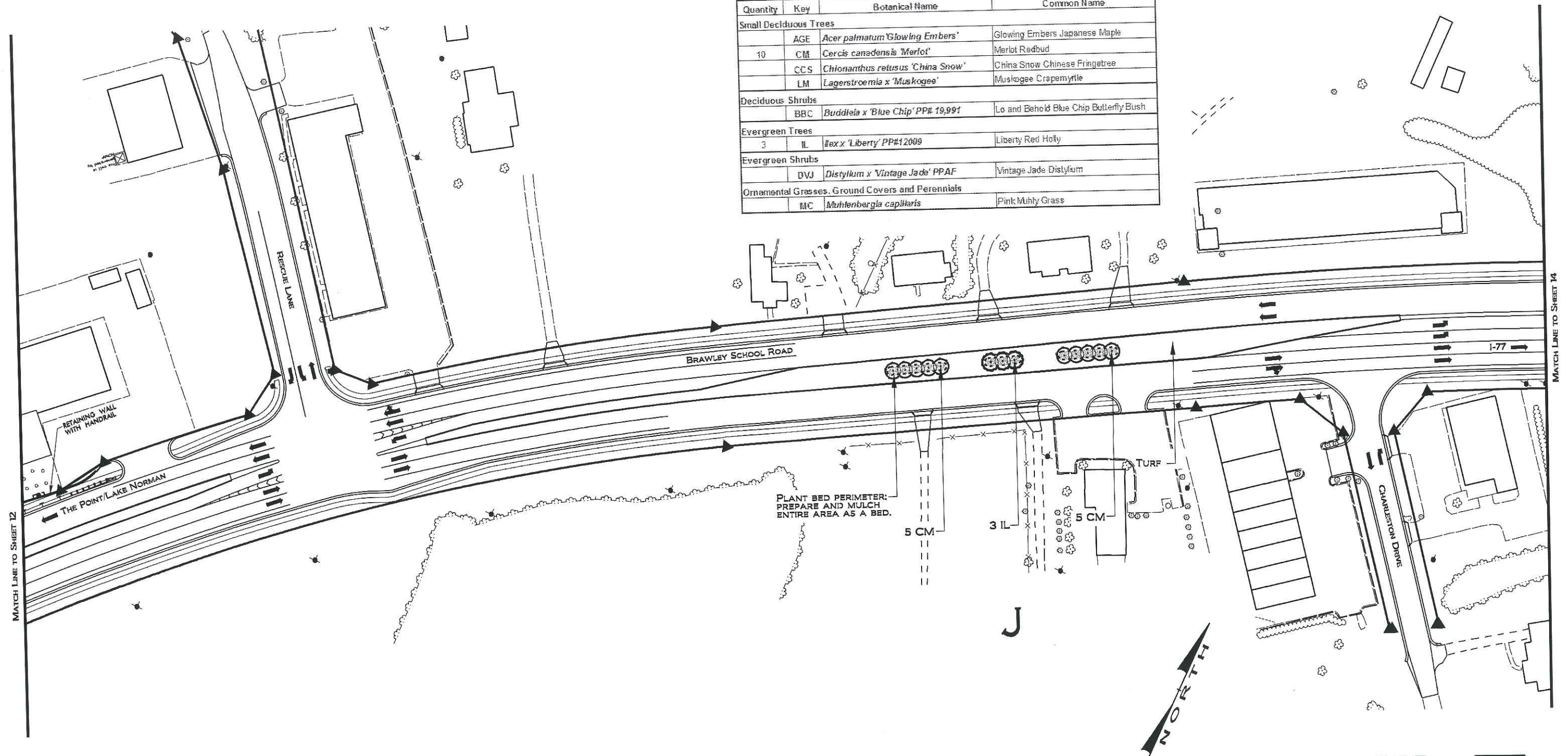

NCDOT - ROADSIDE ENVIRONMENTAL UNIT
 LANDSCAPE DESIGN & DEVELOPMENT
 1557 MAIL SERVICE CENTER RALEIGH NC 27699-1557
 PH: 919-707-2920 FAX: 919-715-2554
[HTTP://WWW.NCDOT.ORG/DOH/OPERATIONS/DP_CHIEF_ENG/ROADSIDE/](http://www.ncdot.org/doh/operations/dp_chief_eng/roadside/)

**BRAWLEY SCHOOL ROAD MEDIAN
 LANDSCAPE PLANTING
 MOORESVILLE, IREDELL COUNTY**

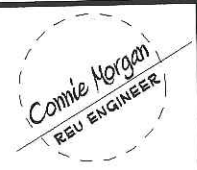

LANDSCAPE DEVELOPMENT
PLANTING PLAN
 MEDIAN J

PRELIMINARY DESIGN DATE: JAN. 10, 2014
 FINAL DESIGN DATE: JUNE 20, 2014
 PROJECT: MOORESVILLE - SR 1100
 BRAWLEY SCHOOL ROAD MEDIAN
 DIVISION AND COUNTY: DIVISION 12 - IREDELL COUNTY

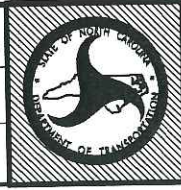

SHEET NO: 13
 TOTAL SHEET NO: 20

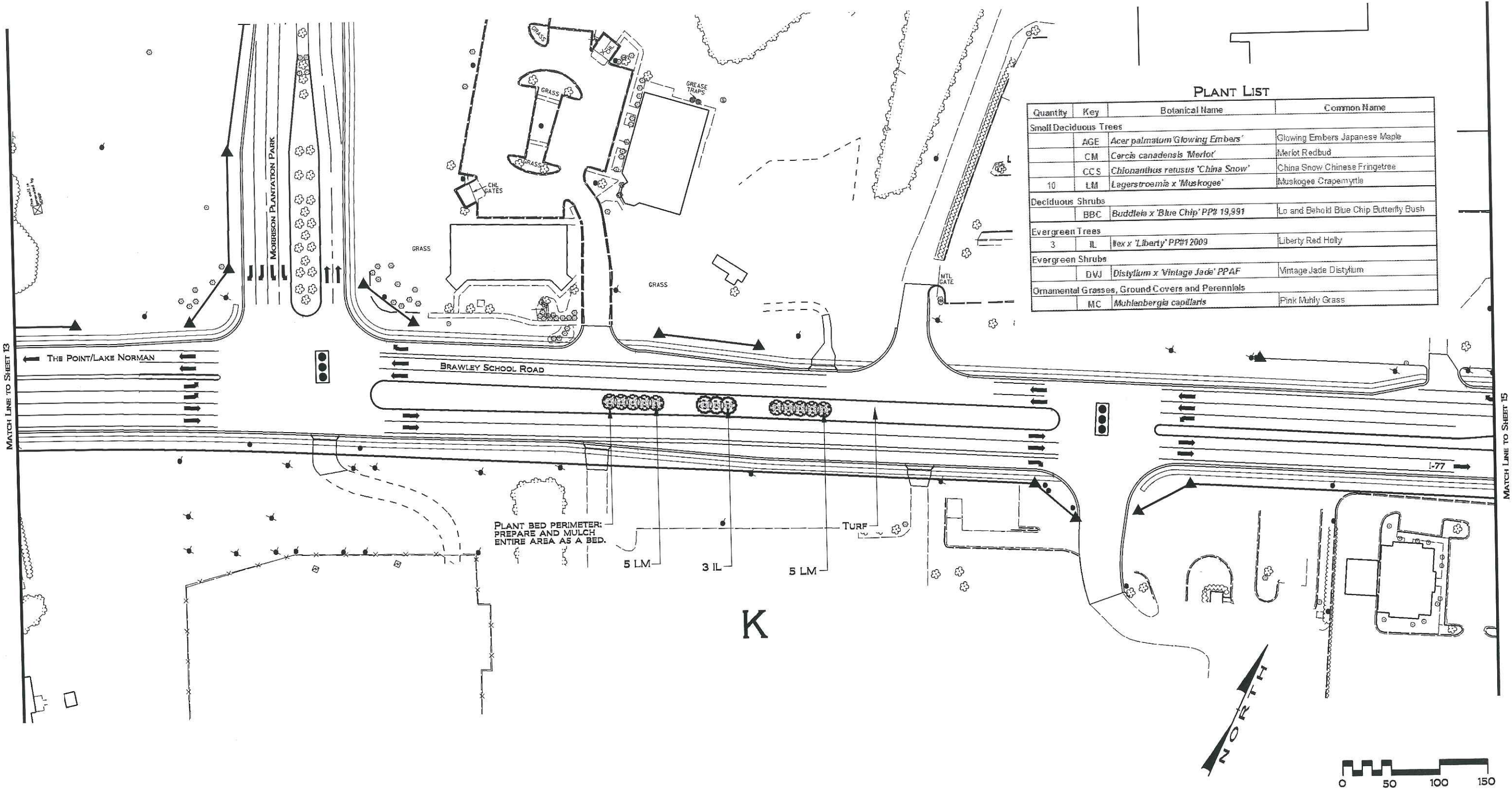

PLANT LIST

Quantity	Key	Botanical Name	Common Name
Small Deciduous Trees			
	AGE	<i>Acer palmatum</i> 'Glowing Embers'	Glowing Embers Japanese Maple
	CM	<i>Cercis canadensis</i> 'Merlot'	Merlot Redbud
	CCS	<i>Chionanthus retusus</i> 'China Snow'	China Snow Chinese Fringetree
10	LM	<i>Lagerstroemia</i> x 'Muskogee'	Muskogee Crapeyrtle
Deciduous Shrubs			
	BBC	<i>Buddleia</i> x 'Blue Chip' PP# 19,991	Lo and Behold Blue Chip Butterfly Bush
Evergreen Trees			
3	IL	<i>Ilex</i> x 'Liberty' PP#12009	Liberty Red Holly
Evergreen Shrubs			
	DVJ	<i>Distylium</i> x 'Vintage Jade' PPAF	Vintage Jade Distylium
Ornamental Grasses, Ground Covers and Perennials			
	MC	<i>Muhlenbergia capillaris</i>	Pink Muhly Grass

K

PLANT BED PERIMETER:
PREPARE AND MULCH
ENTIRE AREA AS A BED.

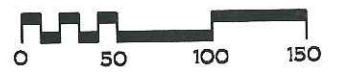
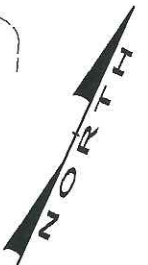

NCDOT - ROADSIDE ENVIRONMENTAL UNIT
LANDSCAPE DESIGN & DEVELOPMENT
 1557 MAIL SERVICE CENTER RALEIGH NC 27699-1557
 PH: 919-707-2920 FAX: 919-715-2554
[HTTP://WWW.NCDOT.ORG/DOH/OPERATIONS/DP_CHIEF_ENG/ROADSIDE/](http://www.ncdot.org/doh/operations/dp_chief_eng/roadside/)

**BRAWLEY SCHOOL ROAD MEDIAN
 LANDSCAPE PLANTING
 MOORESVILLE, IREDELL COUNTY**

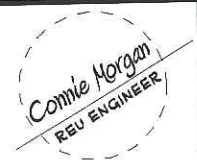

SHEET DESCRIPTION:
LANDSCAPE DEVELOPMENT
PLANTING PLAN
 MEDIAN K

PRELIMINARY DESIGN DATE: JAN. 10, 2014 FINAL DESIGN DATE: JUNE 20, 2014
 PROJECT: MOORESVILLE - SR 1100
 BRAWLEY SCHOOL ROAD MEDIAN
 DIVISION AND COUNTY: DIVISION 12 - IREDELL COUNTY



SHEET NO: **14**
 TOTAL SHEET NO: **20**

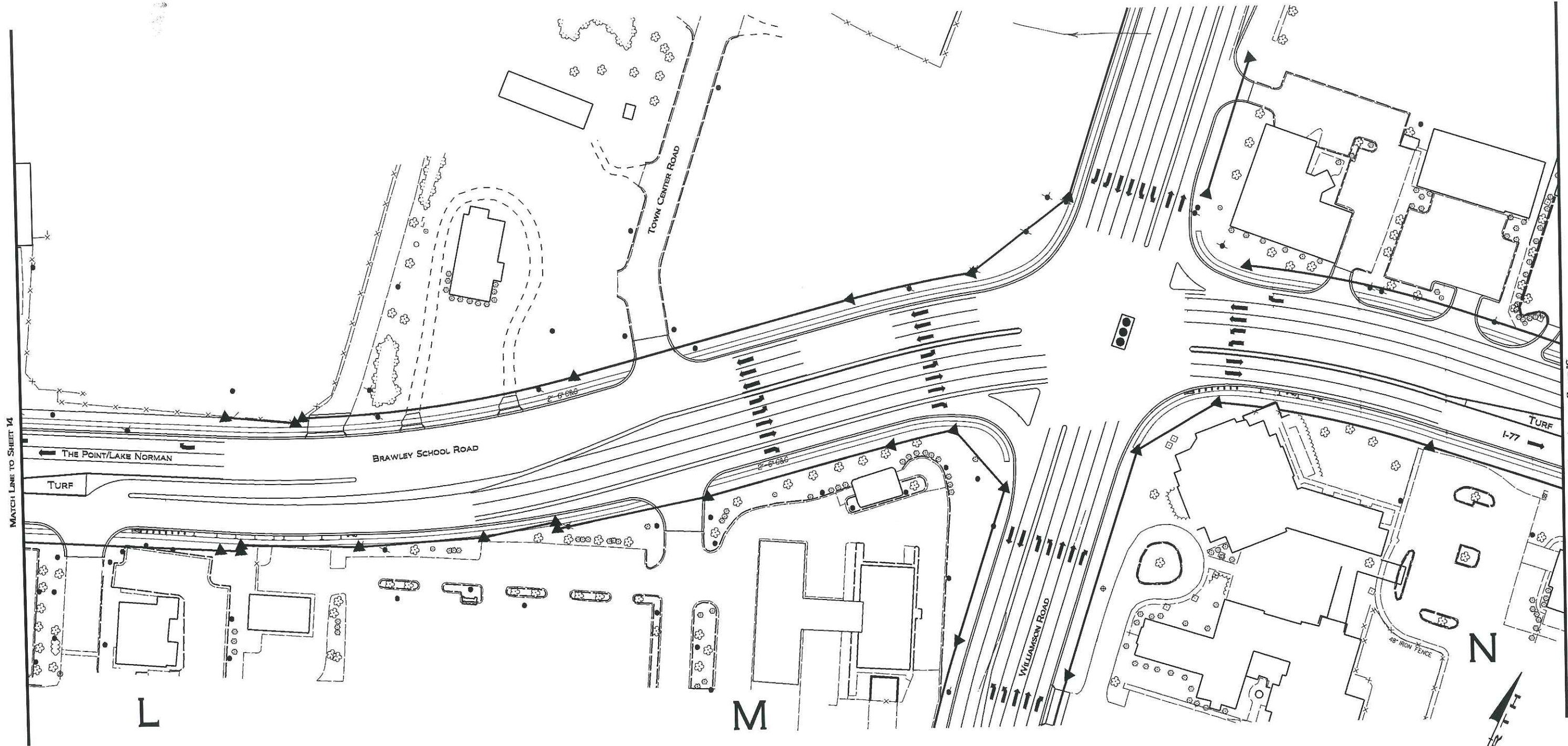

NO PLANTING THIS SHEET

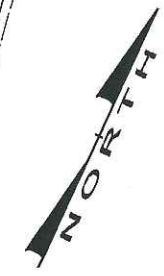

NCDOT - ROADSIDE ENVIRONMENTAL UNIT
 LANDSCAPE DESIGN & DEVELOPMENT
 1557 MAIL SERVICE CENTER RALEIGH, NC 27699-1557
 PH: 919-707-2920 FAX: 919-715-2554
[HTTP://WWW.NCDOT.ORG/DOH/OPERATIONS/DP_CHIEF_ENG/ROADSIDE/](http://www.ncdot.org/doh/operations/dp_chief_eng/roadside/)

**BRAWLEY SCHOOL ROAD MEDIAN
 LANDSCAPE PLANTING
 MOORESVILLE, IREDELL COUNTY**

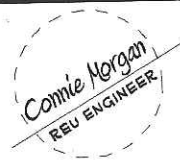

SHEET DESCRIPTION:
 LANDSCAPE DEVELOPMENT
PLANTING PLAN

PRELIMINARY DESIGN DATE: JAN. 10, 2014
 FINAL DESIGN DATE: JUNE 20, 2014
 PROJECT: MOORESVILLE - SR 1100
 BRAWLEY SCHOOL ROAD MEDIAN
 DIVISION AND COUNTY: DIVISION 12 - IREDELL COUNTY



SHEET NO: 15
 TOTAL SHEET NO: 20

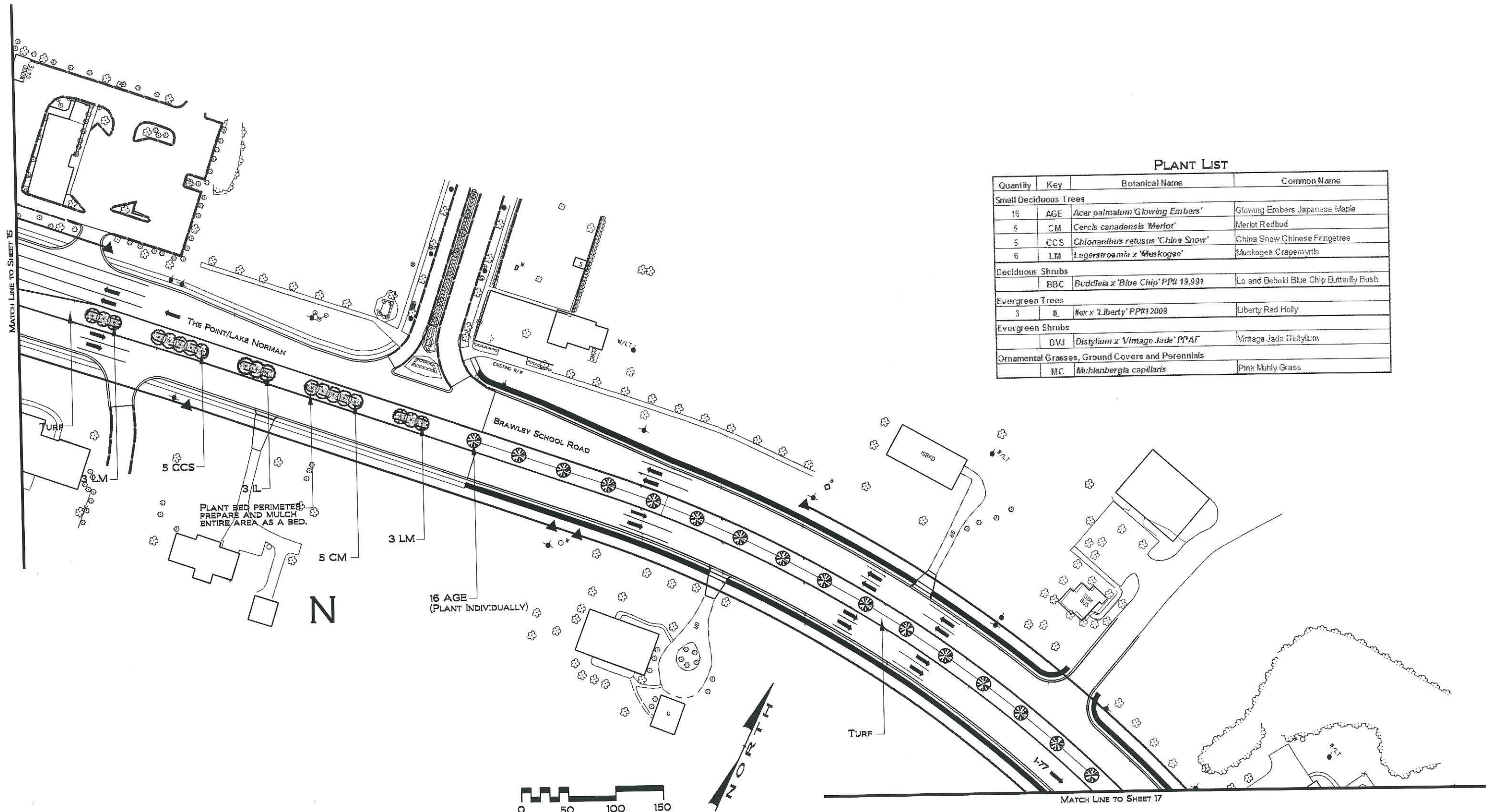

PLANT LIST

Quantity	Key	Botanical Name	Common Name
Small Deciduous Trees			
16	AGE	<i>Acer palmatum</i> 'Glowing Embers'	Glowing Embers Japanese Maple
5	CM	<i>Cercis canadensis</i> 'Merlot'	Merlot Redbud
5	CCS	<i>Chionanthus retusus</i> 'China Snow'	China Snow Chinese Fringetree
6	LM	<i>Lagerstroemia</i> x 'Muskogee'	Muskogee Crapemyrtle
Deciduous Shrubs			
	BBC	<i>Buddleia</i> x 'Blue Chip' PP# 19,991	Lo and Behold Blue Chip Butterfly Bush
Evergreen Trees			
3	IL	#ex x 'Liberty' PP# 12009	Liberty Red Holly
Evergreen Shrubs			
	DVJ	<i>Distylium</i> x 'Vintage Jade' PPAF	Vintage Jade Distylium
Ornamental Grasses, Ground Covers and Perennials			
	MC	<i>Muhlenbergia capillaris</i>	Pink Muhly Grass

 NCDOT - ROADSIDE ENVIRONMENTAL UNIT
LANDSCAPE DESIGN & DEVELOPMENT
 1557 MAIL SERVICE CENTER RALEIGH NC 27699-1557
 PH: 919-707-2920 FAX: 919-715-2554
[HTTP://WWW.NCDOT.ORG/DOH/OPERATIONS/DP_CHIEF_ENG/ROADSIDE/](http://www.ncdot.org/doh/operations/dp_chief_eng/roadside/)

**BRAWLEY SCHOOL ROAD MEDIAN
 LANDSCAPE PLANTING
 MOORESVILLE, IREDELL COUNTY**

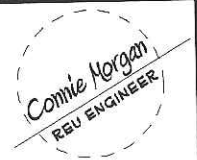

LANDSCAPE DEVELOPMENT
PLANTING PLAN
 MEDIAN N

PRELIMINARY DESIGN DATE: JAN. 10, 2014 FINAL DESIGN DATE: JUNE 20, 2014
 PROJECT: MOORESVILLE - SR 1100
 BRAWLEY SCHOOL ROAD MEDIAN
 DIVISION AND COUNTY: DIVISION 12 - IREDELL COUNTY



SHEET NO: 16
 TOTAL SHEET NO: 20

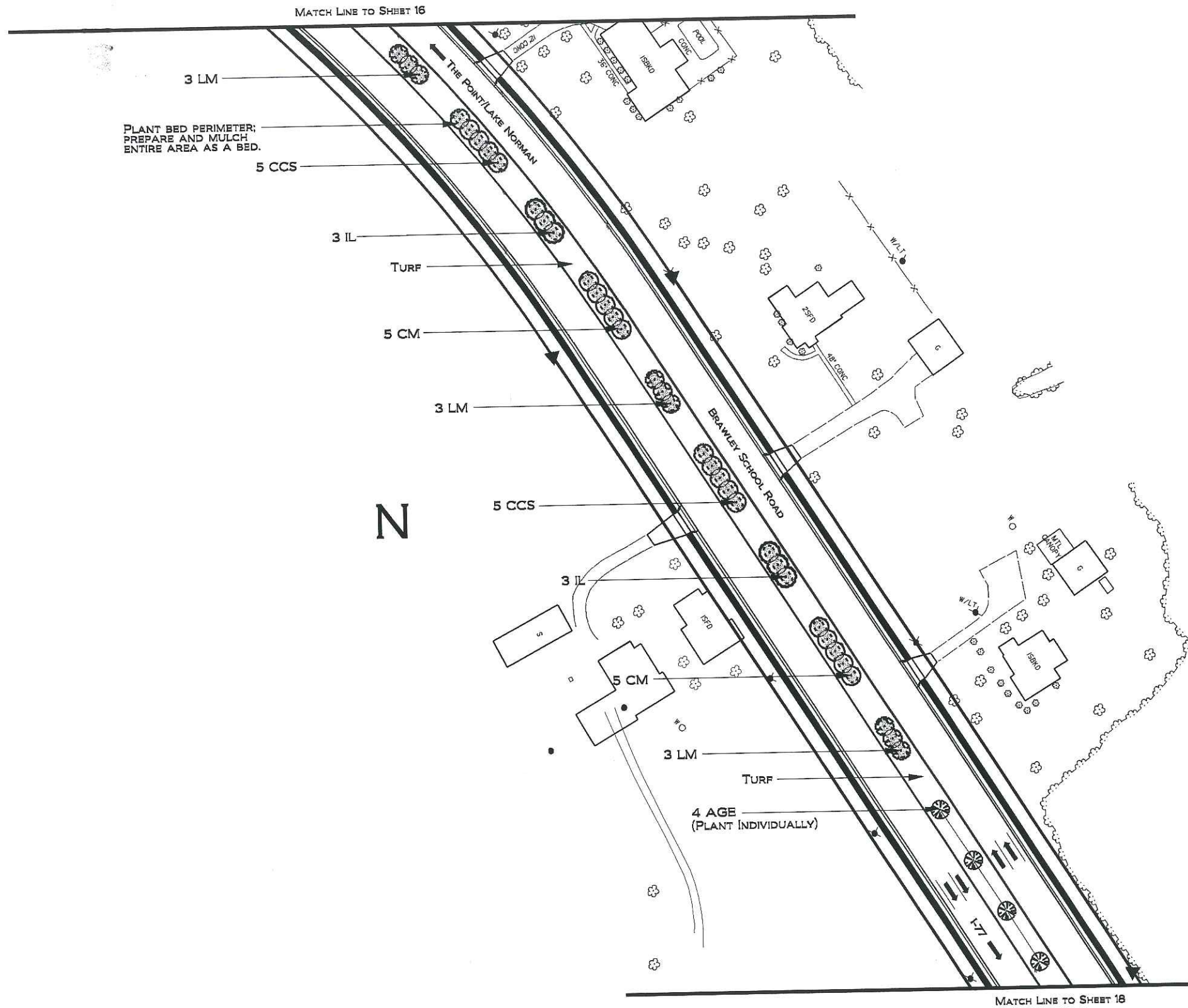

PLANT LIST

Quantity	Key	Botanical Name	Common Name
Small Deciduous Trees			
4	AGE	<i>Acer palmatum</i> 'Glowing Embers'	Glowing Embers Japanese Maple
10	CM	<i>Cercis canadensis</i> 'Merlot'	Merlot Redbud
10	CCS	<i>Chionanthus retusus</i> 'China Snow'	China Snow Chinese Fringetree
9	LM	<i>Lagerstroemia</i> x 'Muskogee'	Muskogee Crapemyrtle
Deciduous Shrubs			
	BBC	<i>Buddleia</i> x 'Blue Chip' PP# 19,991	Lo and Behold Blue Chip Butterfly Bush
Evergreen Trees			
6	IL	<i>Ilex</i> x 'Liberty' PP#12009	Liberty Red Holly
Evergreen Shrubs			
	DVJ	<i>Distylium</i> x 'Vintage Jade' PPAF	Vintage Jade Distylium
Ornamental Grasses, Ground Covers and Perennials			
	MC	<i>Muhlenbergia capillaris</i>	Pink Muhly Grass

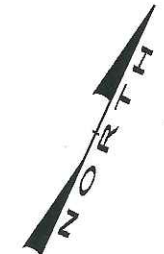

NCDOT - ROADSIDE ENVIRONMENTAL UNIT
 LANDSCAPE DESIGN & DEVELOPMENT
 1557 MAIL SERVICE CENTER RALEIGH NC 27699-1557
 PH: 919-707-2920 FAX: 919-715-2554
[HTTP://WWW.NCDOT.ORG/DOH/OPERATIONS/DP_CHIEF_ENG/ROADSIDE/](http://www.ncdot.org/doh/operations/DP_CHIEF_ENG/ROADSIDE/)

**BRAWLEY SCHOOL ROAD MEDIAN
 LANDSCAPE PLANTING
 MOORESVILLE, IREDELL COUNTY**

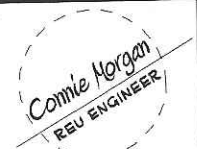

LANDSCAPE DEVELOPMENT
PLANTING PLAN
 MEDIAN N

PRELIMINARY DESIGN DATE: JAN. 10, 2014 FINAL DESIGN DATE: JUNE 20, 2014
 PROJECT: MOORESVILLE - SR 1100
 BRAWLEY SCHOOL ROAD MEDIAN
 DIVISION AND COUNTY: DIVISION 12 - IREDELL COUNTY



SHEET NO: 17
 TOTAL SHEET NO: 20

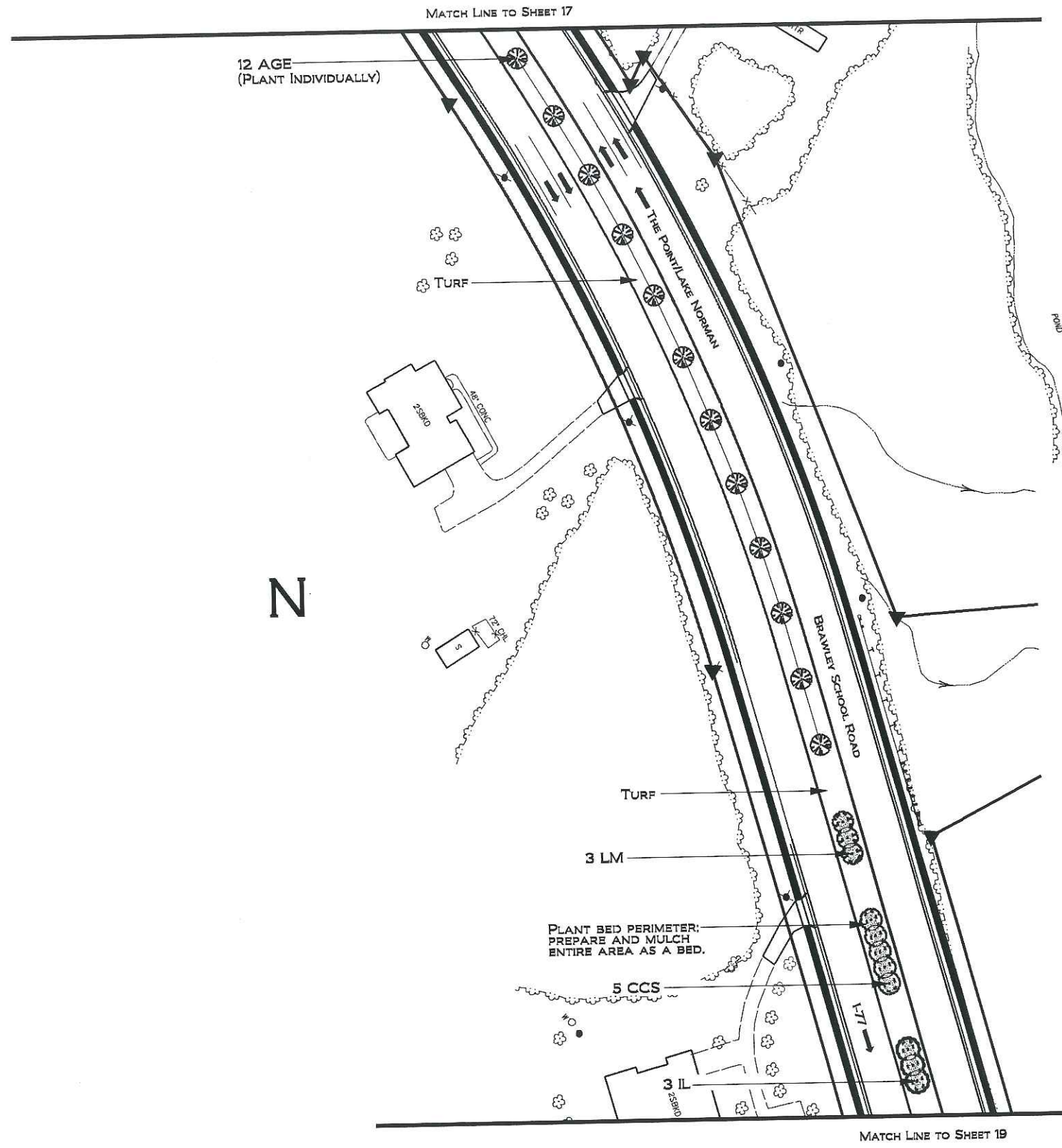

PLANT LIST

Quantity	Key	Botanical Name	Common Name
Small Deciduous Trees			
12	AGE	<i>Acer palmatum</i> 'Glowing Embers'	Glowing Embers Japanese Maple
	CM	<i>Cercis canadensis</i> 'Merlot'	Merlot Redbud
5	CCS	<i>Chionanthus retusus</i> 'China Snow'	China Snow Chinese Fringetree
3	LM	<i>Lagerstroemia</i> x 'Muskogee'	Muskogee Crape Myrtle
Deciduous Shrubs			
	BBC	<i>Buddleia</i> x 'Blue Chip' PP# 19,991	Lo and Behold Blue Chip Butterfly Bush
Evergreen Trees			
3	IL	#ex x 'Liberty' PP#12009	Liberty Red Holly
Evergreen Shrubs			
	DVJ	<i>Distylium</i> x 'Vintage Jade' PPAF	Vintage Jade Distylium
Ornamental Grasses, Ground Covers and Perennials			
	MC	<i>Muhlenbergia capillaris</i>	Pink Muhly Grass

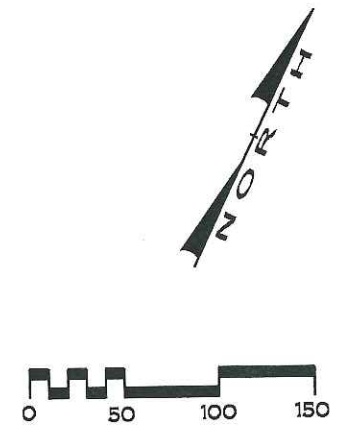

NCDOT - ROADSIDE ENVIRONMENTAL UNIT
LANDSCAPE DESIGN & DEVELOPMENT
 1557 MAIL SERVICE CENTER RALEIGH NC 27699-1557
 PH: 919-707-2920 FAX: 919-715-2554
[HTTP://WWW.NCDOT.ORG/DOH/OPERATIONS/DP_CHIEF_ENG/ROADSIDE/](http://www.ncdot.org/doh/operations/dp_chief_eng/roadside/)

**BRAWLEY SCHOOL ROAD MEDIAN
 LANDSCAPE PLANTING
 MOORESVILLE, IREDELL COUNTY**

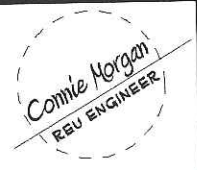

LANDSCAPE DEVELOPMENT
PLANTING PLAN
 MEDIAN N

PRELIMINARY DESIGN DATE: JAN. 10, 2014 FINAL DESIGN DATE: JUNE 20, 2014
 PROJECT: MOORESVILLE - SR 1100
BRAWLEY SCHOOL ROAD MEDIAN
 DIVISION AND COUNTY:
 DIVISION 12 - IREDELL COUNTY



SHEET NO: **18**
 TOTAL SHEET NO: **20**

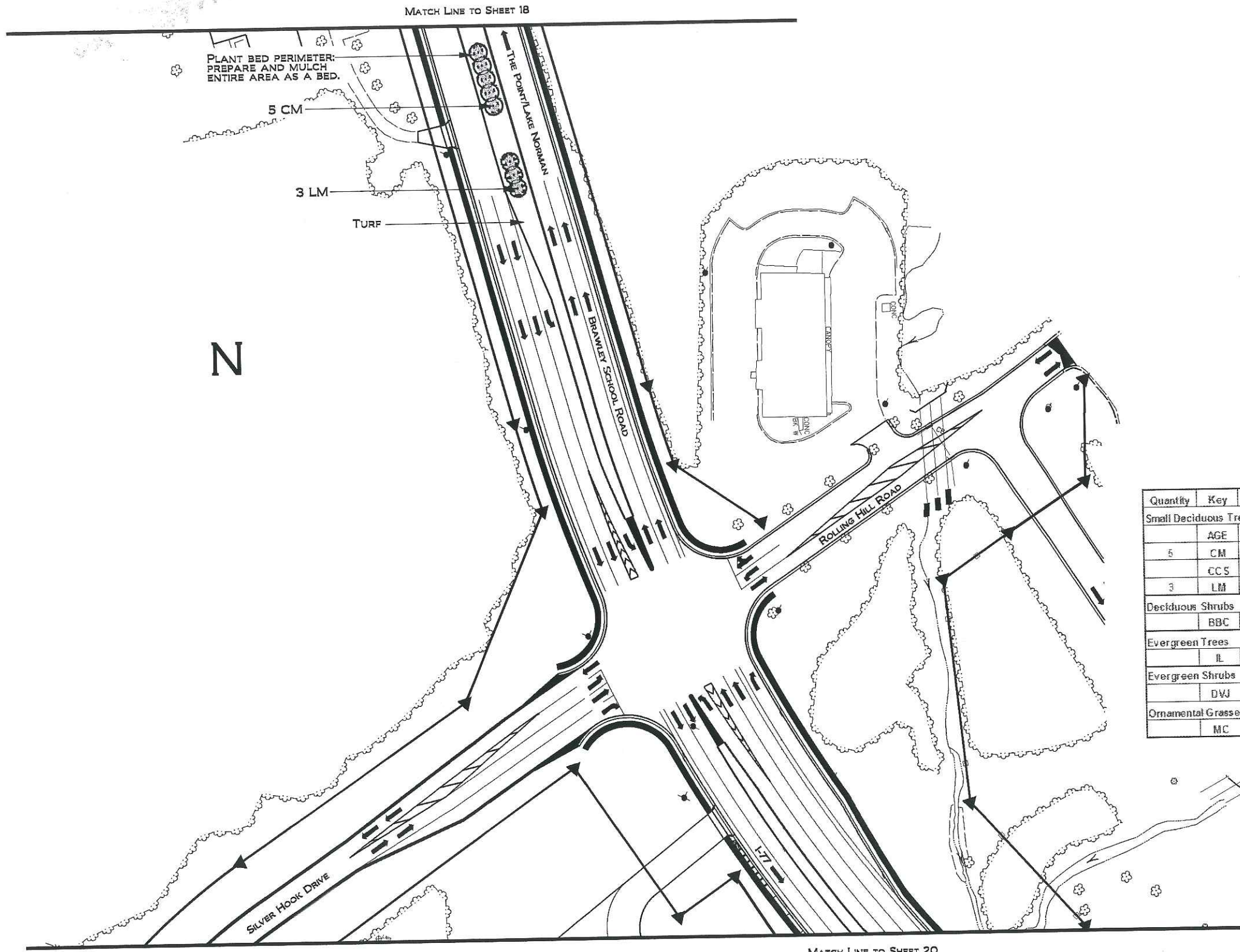

PLANT BED PERIMETER:
PREPARE AND MULCH
ENTIRE AREA AS A BED.

5 CM

3 LM

TURF

N

PLANT LIST

Quantity	Key	Botanical Name	Common Name
Small Deciduous Trees			
	AGE	<i>Acer palmatum</i> 'Glowing Embers'	Glowing Embers Japanese Maple
5	CM	<i>Cercis canadensis</i> 'Merlot'	Merlot Redbud
	CCS	<i>Chionanthus retusus</i> 'China Snow'	China Snow Chinese Fringetree
3	LM	<i>Lagerstroemia x 'Muskogae'</i>	Muskogee Crapehyrtle
Deciduous Shrubs			
	BBC	<i>Buddleia x 'Blue Chip'</i> PPR 19,991	Lo and Behold Blue Chip Butterfly Bush
Evergreen Trees			
	IL	<i>Ilex x 'Liberty'</i> PPA12009	Liberty Red Holly
Evergreen Shrubs			
	DVJ	<i>Distylium x 'Vintage Jade'</i> PPAF	Vintage Jade Distylium
Ornamental Grasses, Ground Covers and Perennials			
	MC	<i>Muhlenbergia capillaris</i>	Pink Muhly Grass

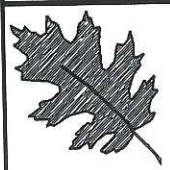
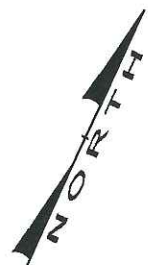

NCDOT - ROADSIDE ENVIRONMENTAL UNIT
 LANDSCAPE DESIGN & DEVELOPMENT
 1557 MAIL SERVICE CENTER RALEIGH NC 27699-1557
 PH: 919-707-2920 FAX: 919-715-2554
[HTTP://WWW.NCDOT.ORG/DOH/OPERATIONS/DP_CHIEF_ENG/ROADSIDE/](http://www.ncdot.org/DOH/OPERATIONS/DP_CHIEF_ENG/ROADSIDE/)

BRAWLEY SCHOOL ROAD MEDIAN
 LANDSCAPE PLANTING
 MOORESVILLE, IREDELL COUNTY

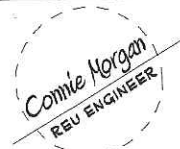

LANDSCAPE DEVELOPMENT
 PLANTING PLAN
 MEDIAN N

PRELIMINARY DESIGN DATE: JAN. 10, 2014
 FINAL DESIGN DATE: JUNE 20, 2014
 PROJECT: MOORESVILLE - SR 1100
 BRAWLEY SCHOOL ROAD MEDIAN
 DIVISION AND COUNTY: DIVISION 12 - IREDELL COUNTY



SHEET NO: 19
 TOTAL SHEET NO: 20

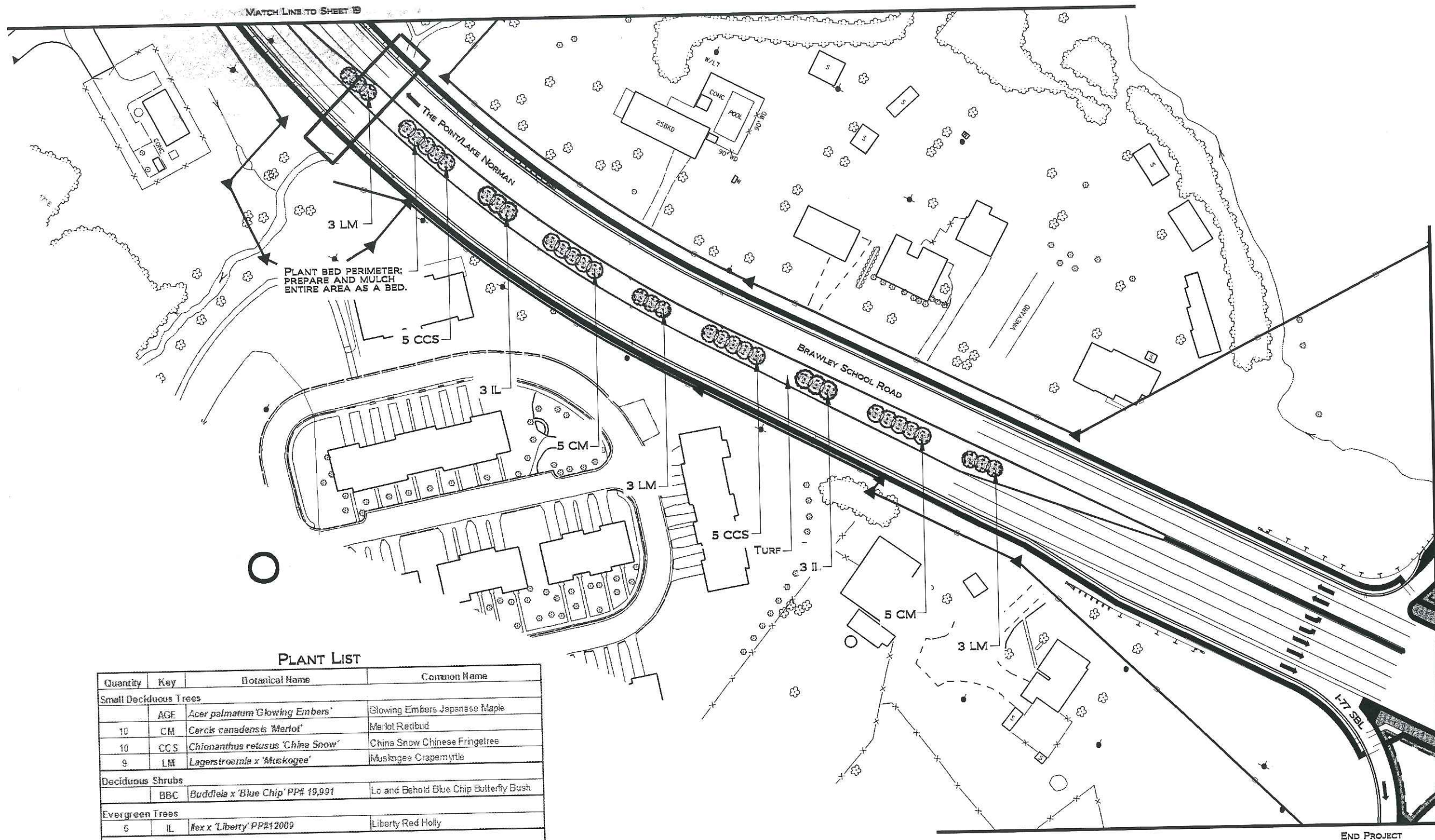

PLANT LIST

Quantity	Key	Botanical Name	Common Name
Small Deciduous Trees			
	AGE	<i>Acer palmatum</i> 'Glowing Embers'	Glowing Embers Japanese Maple
10	CM	<i>Cercis canadensis</i> 'Merlot'	Merlot Redbud
10	CCS	<i>Chionanthus retusus</i> 'China Snow'	China Snow Chinese Fringetree
9	LM	<i>Lagerstroemia</i> x 'Muskogee'	Muskogee Crape myrtle
Deciduous Shrubs			
	BBC	<i>Buddleia</i> x 'Blue Chip' PP# 10,991	Lo and Behold Blue Chip Butterfly Bush
Evergreen Trees			
6	IL	<i>Ilex</i> x 'Liberty' PP#12009	Liberty Red Holly
Evergreen Shrubs			
	DVJ	<i>Distylium</i> x 'Vintage Jade' PPAF	Vintage Jade Distylium
Ornamental Grasses, Ground Covers and Perennials			
	MC	<i>Muhlenbergia capillaris</i>	Pink Muhly Grass

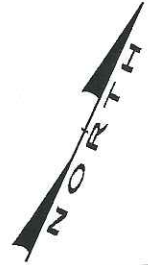

NCDOT - ROADSIDE ENVIRONMENTAL UNIT
LANDSCAPE DESIGN & DEVELOPMENT
 1557 MAIL SERVICE CENTER RALEIGH NC 27699-1557
 PH: 919-707-2920 FAX: 919-715-2554
[HTTP://WWW.NCDOT.ORG/DOH/OPERATIONS/DP_CHIEF_ENG/ROADSIDE/](http://www.ncdot.org/doh/operations/dp_chief_eng/roadside/)

**BRAWLEY SCHOOL ROAD MEDIAN
 LANDSCAPE PLANTING
 MOORESVILLE, IREDELL COUNTY**

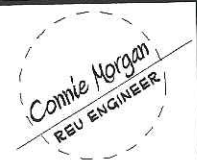

SHEET DESCRIPTION:
LANDSCAPE DEVELOPMENT
PLANTING PLAN
 MEDIAN 0

PRELIMINARY DESIGN DATE: JAN. 10, 2014 FINAL DESIGN DATE: JUNE 20, 2014
 PROJECT: MOORESVILLE - SR 1100
 BRAWLEY SCHOOL ROAD MEDIAN
 DIVISION AND COUNTY: DIVISION 12 - IREDELL COUNTY



SHEET NO: **20**
 TOTAL SHEET NO: **20**